

TOWED 23x152MM ANTI-AIRCRAFT TWIN-BARRELED AUTOCANNON ZU-23-2

HISTORICAL BRIEF
AND TECHNICAL BACKGROUND

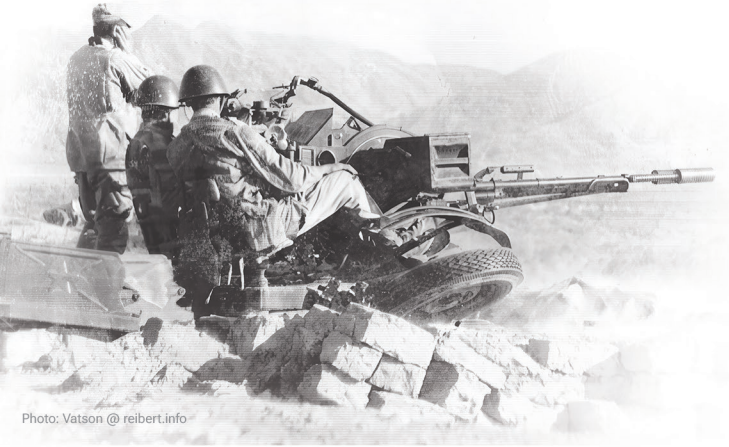

Photo: Vatson @ reibert.info

The ZU-23-2 (USSR GRAU index 2A13) is a 23-mm twin anti-aircraft gun developed in the late 1950s and adopted in 1960. It is designed to engage low-flying air targets, such as aircraft and helicopters, as well as enemy ground vehicles and manpower.

HISTORY OF DEVELOPMENT

After the Second World War, it became clear that the available anti-aircraft weapons did not meet the requirements of modern warfare. In particular, they were not effective enough against new types of attack aircraft and helicopters. In this regard, work began on the development of new anti-aircraft systems. One of these developments was the ZU-23-2.

TECHNICAL CHARACTERISTICS

ZU-23-2 consists of two 23-mm 2A14 automatic anti-aircraft guns mounted on a single carriage. The system is wheeled, which makes it easy to transport.

- Calibre: 23 mm
- Number of barrels: 2
- Rate of fire: approximately 2000 rounds per minute (combined)
- Effective range (aerial targets): up to 2.5 km
- Maximum effective altitude (aerial targets): up to 1.5 km
- Installation weight: approx. 950 kg
- Manning: 5 people

COMBAT USE

The ZU-23-2 was actively used in various armed conflicts, such as the Vietnam War, the Arab-Israeli wars, the war in Afghanistan and others. It has proven to be an effective short-range air defence and fire support system for ground forces.

The ZU-23-2 is one of the most widely used and recognisable air defence systems in the world. It is still in service in many countries and continues to perform its combat missions.

kaliber
38mm

TOWED 23x152MM ANTI-AIRCRAFT
TWIN-BARRELED AUTOCANNON

ZU-23-2

K38-72101

SCALE MODEL KIT

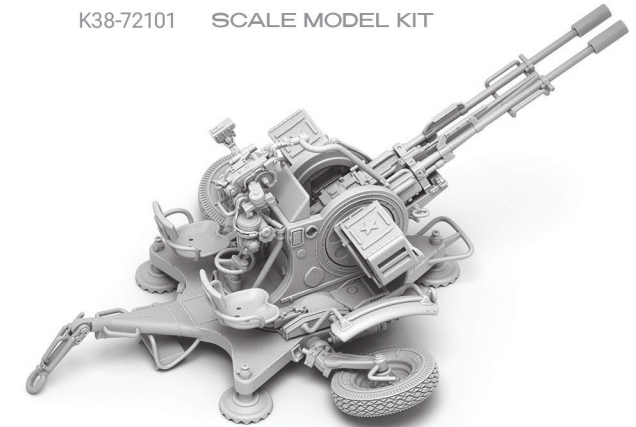

MADE IN UKRAINE 

ASSEMBLY INSTRUCTIONS

K38-72101

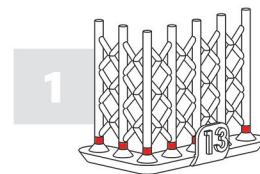

Remove the base of the supports with sharp modelling nippers. If necessary, use a modelling saw.

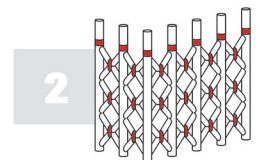

Remove the main support array by splitting the cross connections and removing the main supports.

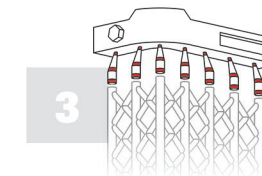

Remove the remaining supports in several steps, moving closer to the base of the tips on the part.

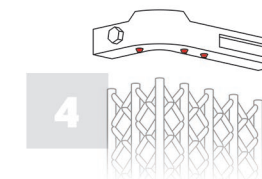

If necessary, use a file or a suitable mini-drill bit to clean the joint between the tips and the part.

A



IMPORTANT:
If you are assembling the model in the towing mode, use parts **15** **16** instead of **13** **14** respectively.

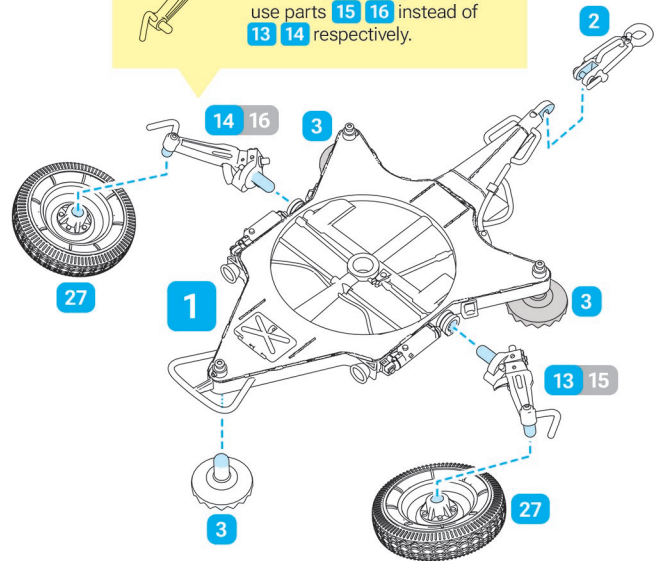

B

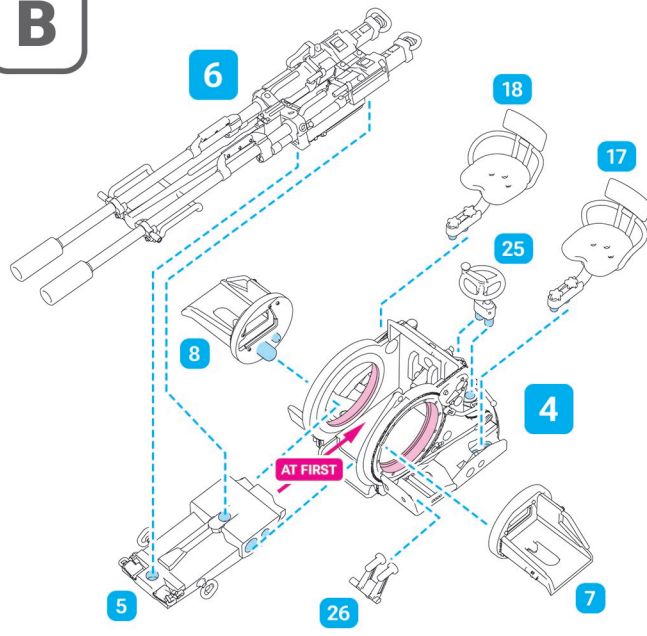

C

The elevation angle of the anti-aircraft sight **22** must be equal to the elevation angle of the autocannons.

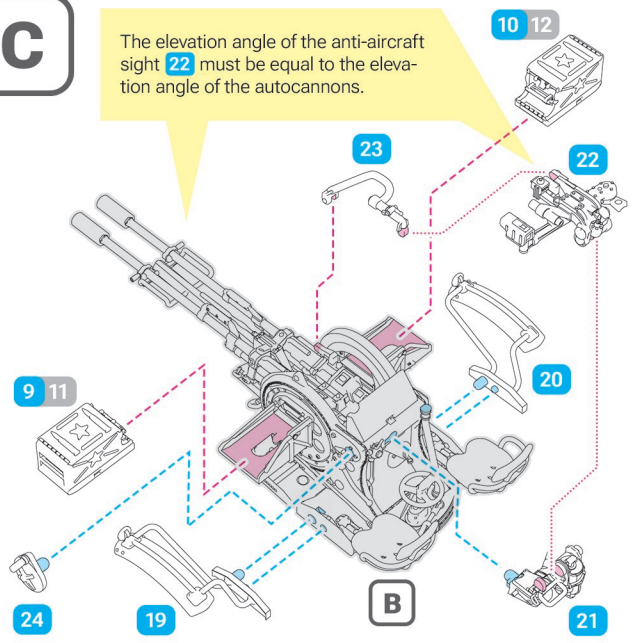

D

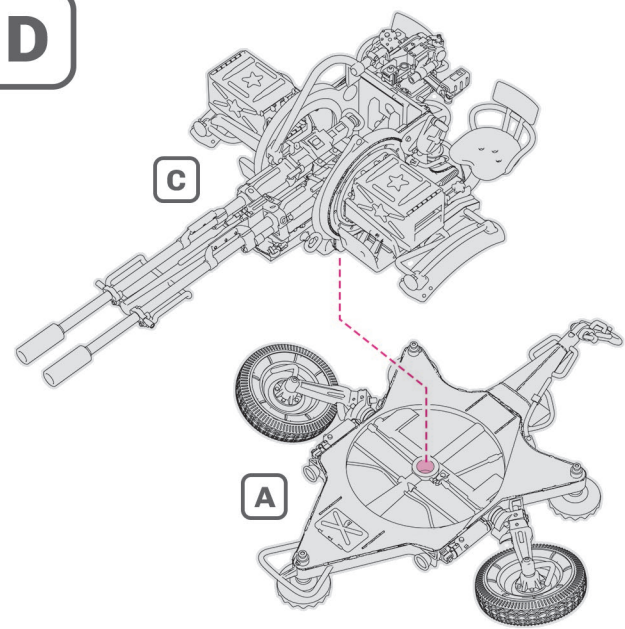

**ASSEMBLY OPTION №1
COMBAT MODE**

SIDE VIEW

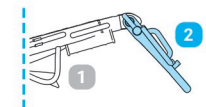

FRONT VIEW

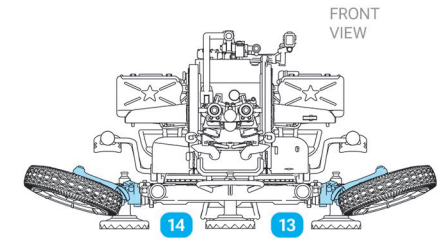

**ASSEMBLY OPTION №2
TOWING MODE**

SIDE VIEW

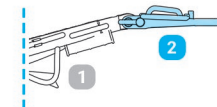

FRONT VIEW

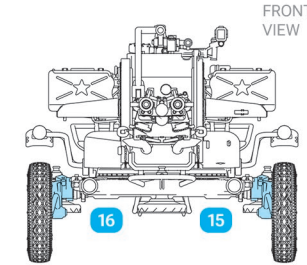

3 x3



REMOVE THE DESIGNATED PORTION

ELEVATION ANGLE

Set the same elevation angles between -10° and $+90^\circ$ for the autocannons **5** **6** **7** **8** and the sight **22** relative to the horizon and lock the position with the rod **23**

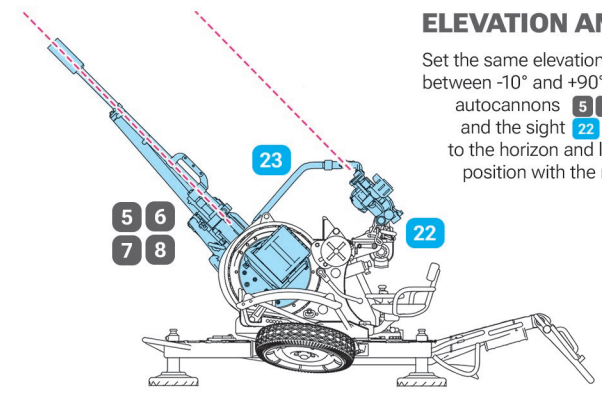

13 — part number or **9** **11** assembly options.

A or — group of assembled parts.

— assembly with or without glue.

kaliber
38mm

K38-72301

"FULL AMMUNITION"
ACCESSORIES KIT FOR

ZU-23-2

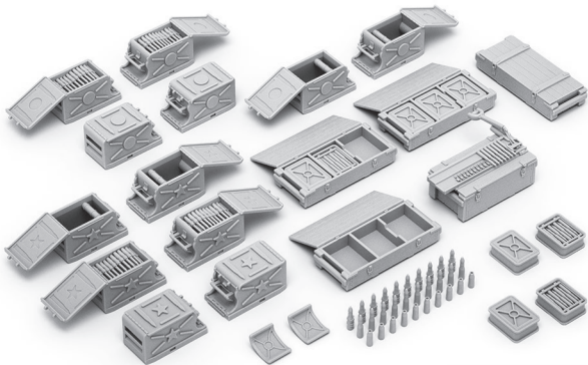

MADE IN UKRAINE

1:72