



Ju 88A-5

Германский бомбардировщик II MB

В начале 30-х годов в мире возникла идея создания скоростного бомбардировщика, который мог бы обогнать современные ему истребители-бипланы. Одним из воплощений этой концепции стал двухмоторный бомбардировщик Ju 88, разработанный германской фирмой Юнкерс Флюгzeug – унд Моторенверке.

С весны 1940 г. началось производство самолетов Ju 88A-5 с крылом увеличенного размаха, на которых были установлены двигатели жидкостного охлаждения Jumo 211G-1 либо H-1.

В 1940-1941 г. были выпущены около 2000 бомбардировщиков Ju 88A-5. Они принимали участие во всех операциях Люфтваффе конца 1940-1941 г.г. – в битве за Британию, а также на Балканах и на советско-германском фронте.

Тактико-технические характеристики Ju 88A-5

Длина, м	14,36
Размах крыла, м.....	20,08
Взлетный вес, кг	12450
Двигатель	2xJumo 211G-1 или H-1, 1200 л.с.
Максимальная скорость, км/ч.....	475
Потолок, м.....	8500
Дальность, км	2950
Вооружение	5x7,92-мм пулеметов MG 15, до 2500 кг бомб

ВНИМАНИЕ!

Перед сборкой внимательно прочитать руководство по монтажу. Каждая деталь пронумерована. Соблюдать последовательность монтажа. Необходимые рабочие инструменты: нож и напильник для зачистки деталей; резиновая лента, клейкая лента и зажимы для сушки белья для прижимания склеиваемых деталей. Детали из пластика очистить в растворе мягкого моющего средства и высушить на воздухе для того, чтобы краска и переводные картинки лучше прилипали. Перед приклеиванием проверить, подходят ли детали; клей наносить экономно. Хром и краску удалить с поверхности склеивания. Небольшие детали покрасить перед тем, как они будут удалены из рамок. Краску необходимо хорошо просушить, только после этого продолжать сборку. Каждую соответствующую переводную картинку отдельно вырезать и примерно на 20 секунд окунуть в теплую воду. На обозначенном месте картинку отделить от бумаги и прижать промокательной бумагой.

ИСПОЛЬЗУЕМЫЕ КРАСКИ / USED COLORS:

	Model Master		
A	1749	Черный, матовый	Flat Black
B	1768	Белый, матовый	Flat White
C	2072	Желтый RLM04	Gelb RLM04
D	2080	Черно-зеленый RLM 70	Schwarzgrun RLM70
E	2081	Темно-зеленый RLM71	Dunkelgrun RLM71
F	2078	Голубой RLM65	Hellblau RLM65
G	2079	Черно-серый, матовый	Schwarzgrau RLM66

Ju 88A-5

WWII German Bomber

In the beginning of 30s it was appeared in the world an idea of high-speed bomber that could outstrip contemporary fighters. One of the objectifications of this conception became the twin-engine bomber Ju 88 designed by a German Junkers Flugzeug - und Motorenwerke AG company.

Since the spring of 1940 it were produced Ju 88A-5 planes with the wing of increased span and liquid-cooled Jumo 211G-1 or H-1 engines.

In 1940-1941 it were produced about 2000 Ju 88A-5 bombers. They took part in all late 1940-1941 Luftwaffe operations – in the Battle of Britain, and also in Balkans and in the Eastern Front.

Tactical and Technical Specifications of Ju 88A-5

Length, m	14,36
Wingspan, m	20,08
Start Weight, kg.....	12450
Engine.....	2xJumo 211G-1 or H-1, 1200 hp
Max. Speed, km/h.....	475
Service Ceiling, m.....	8500
Range, km	2950
Armament.....	5x7,92 mm MG 15, bomb load - up to 2500 kg

CAUTION!

Read the instructions thoroughly prior to assembly. Each component is numbered. Adhere to specified sequence of assembly. Tools required: knife and file for removal of components from frame; rubber bond, adhesive tape and clothes pegs for clamping components together after applying adhesive. Clean plastic components in a mild detergent solution and allow to air-dry so that paint and transfers adhere better. Prior to applying adhesive, check to see whether the components fit together; apply adhesive sparingly. Remove chrome and paint from the contact surfaces. Paint small components before removing them from the frame. Allow paint to dry well, and only then continue to assemble. Cut out each transfer individually and immerse in warm water for approx. 20 seconds. Slide transfer off paper and into designated position, then press on with blotting paper.

	Model Master		
H	2071	Серо-зеленый RLM02	Grau RLM02
J	1781	Алюминий, полуматовый	Aluminum
K	1780	Сталь	Steel
L	1795	Темный металл	Gun Metal
M	1785	Ржавчина	Rust
N	1705	Красный, матовый	Insignia Red
P	1571	Зеленый, матовый	Flat Green

01 СТАДИЯ СБОРКИ
ASSEMBLY STEP

03 СБОРОЧНАЯ ЕДИНИЦА
ASSEMBLY UNIT

A ИСПОЛЬЗУЕМАЯ КРАСКА
USED COLOR

NE НЕ КЛЕИТЬ
DO NOT CEMENT

x2 СДЕЛАТЬ ДВЕ ДЕТАЛИ
MAKE 2 PCS

□ ПРИ СБОРКЕ НЕ ИСПОЛЬЗУЕТСЯ
PARTS NOT FOR USE

✂ ОТРЕЗАТЬ
CUT OFF

***** СДЕЛАТЬ САМОМУ
SCRATCH BUILD

? ПРОИЗВОЛЬНЫЙ ВЫБОР
OPTIONAL

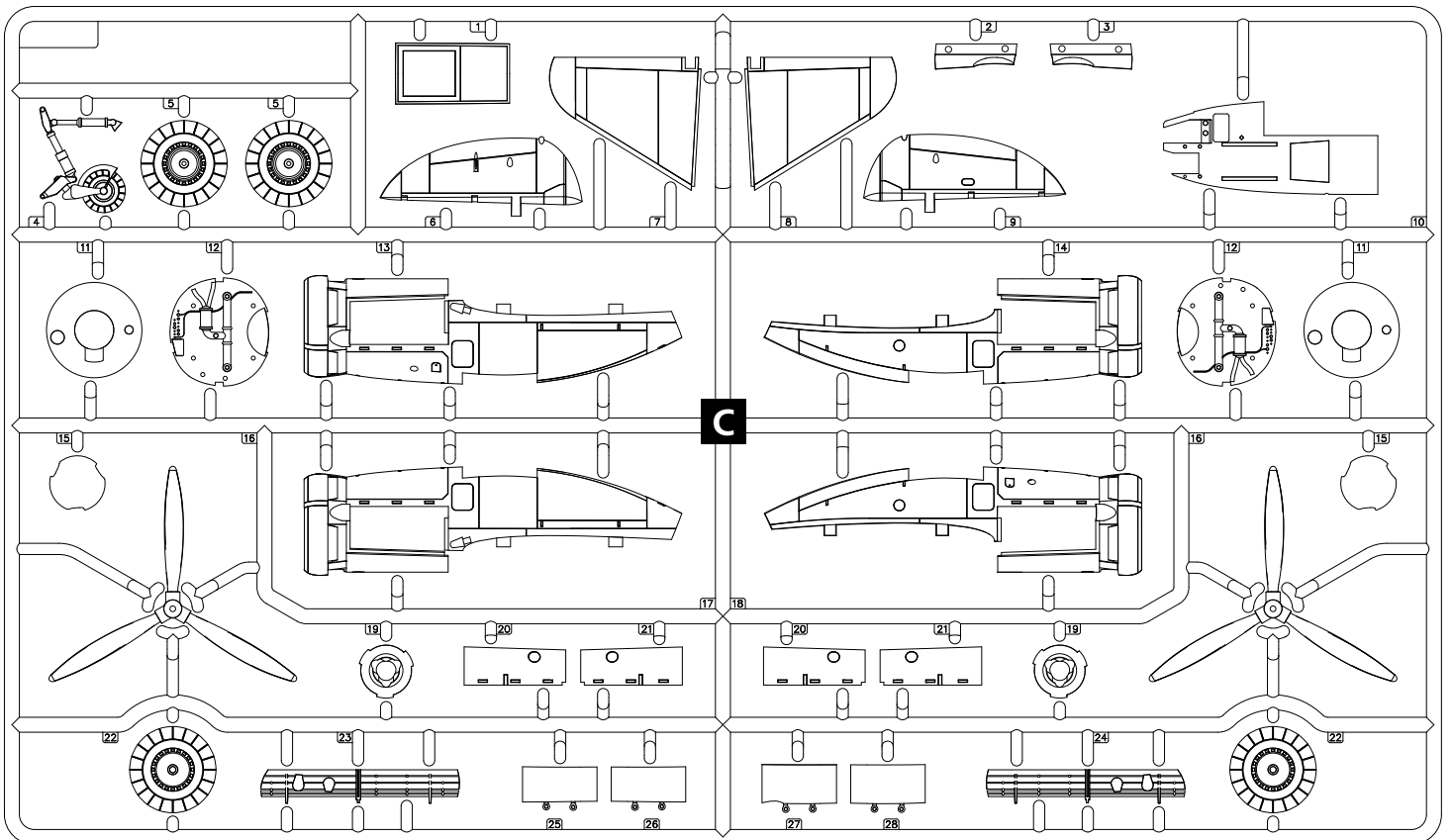
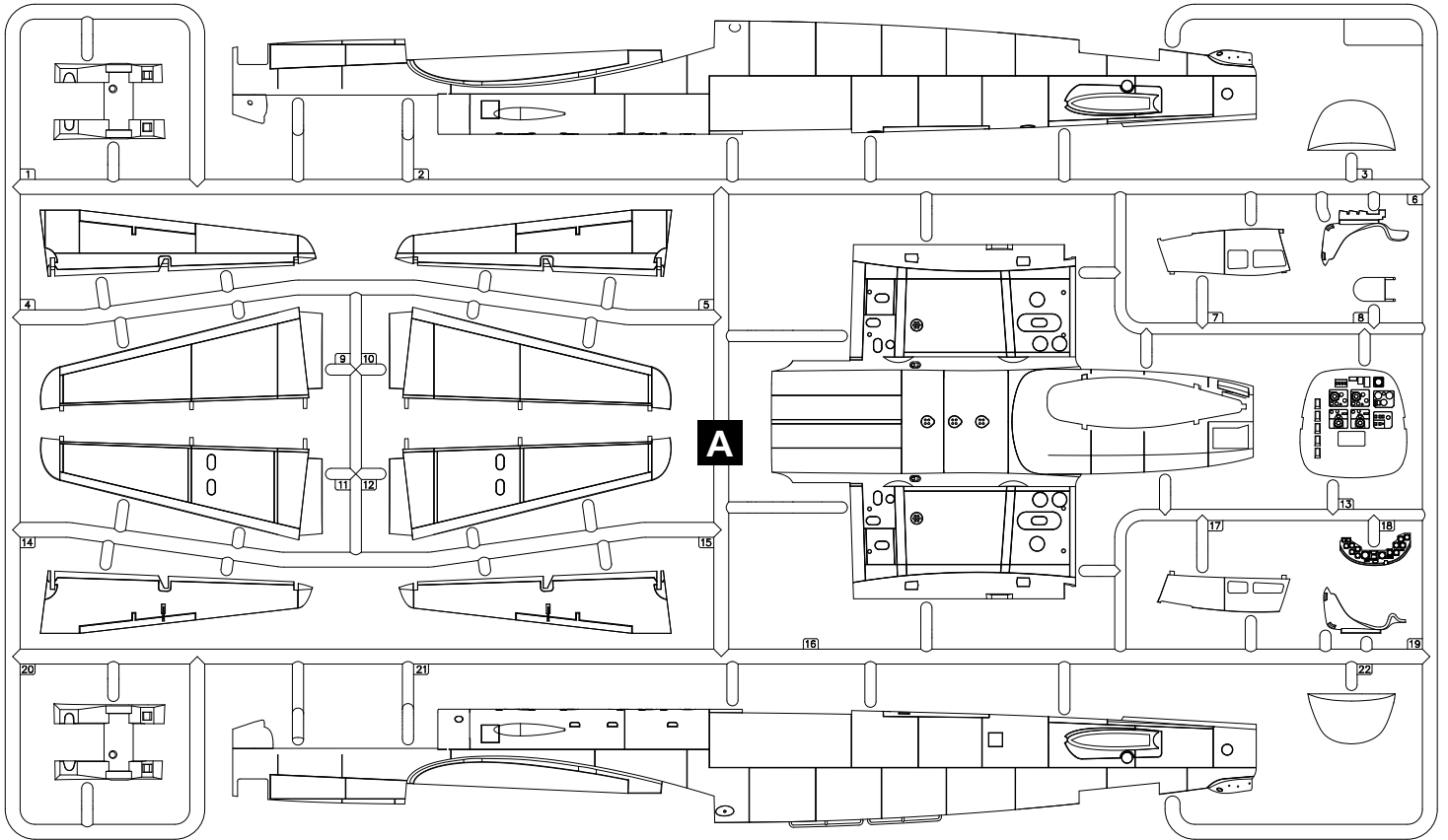

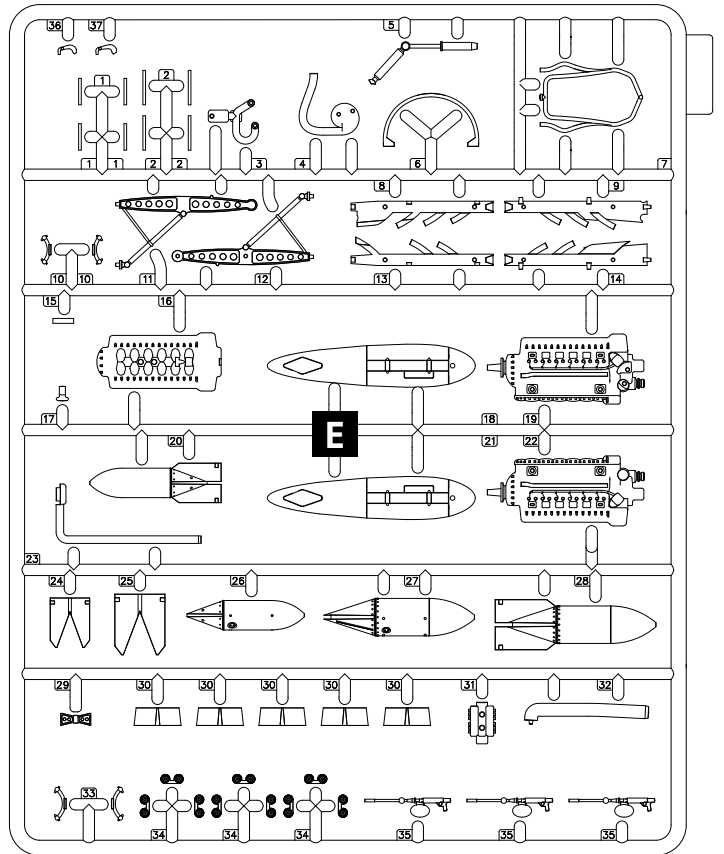
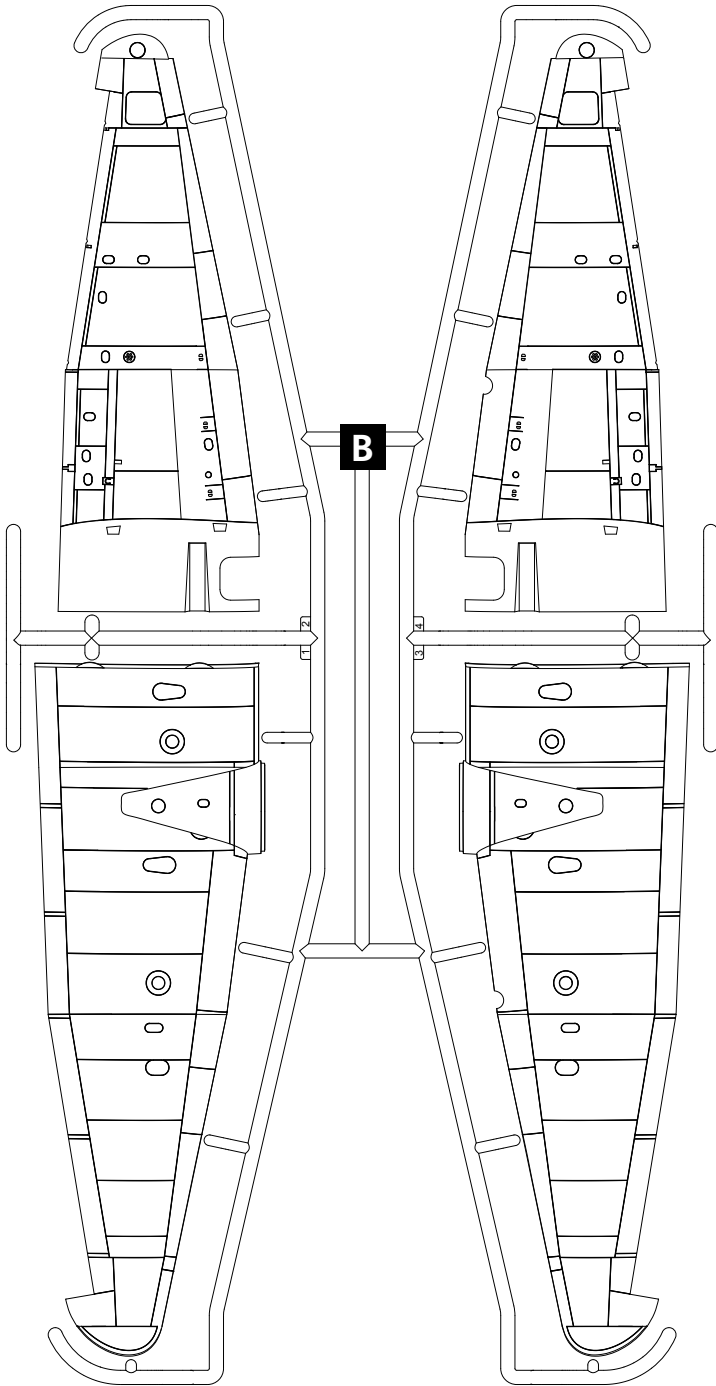

x2

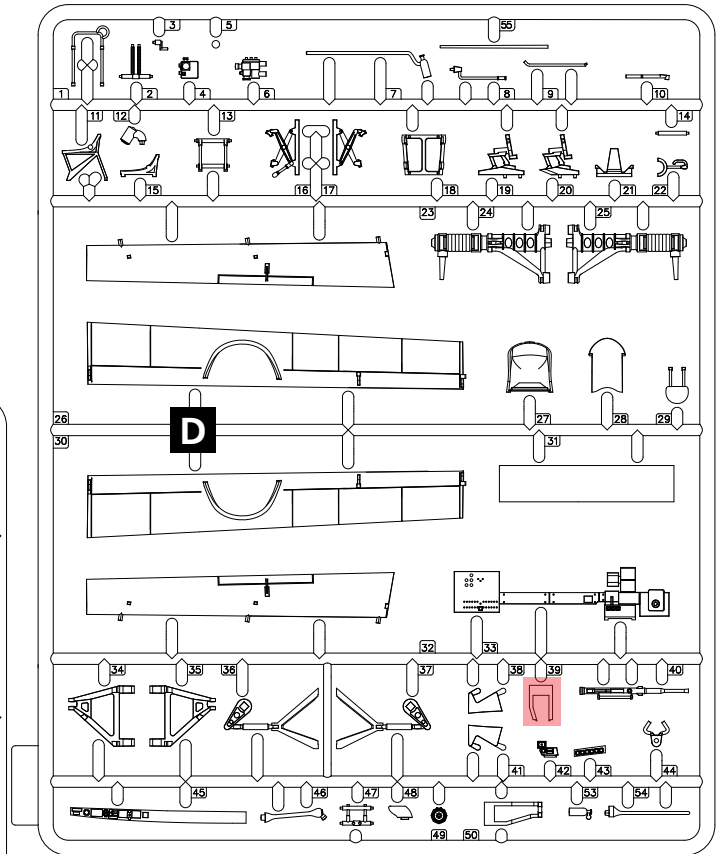
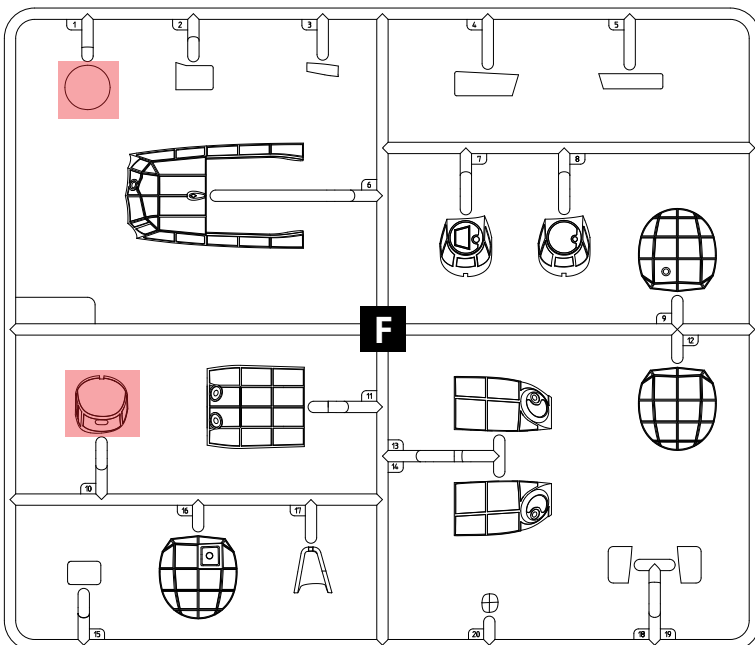

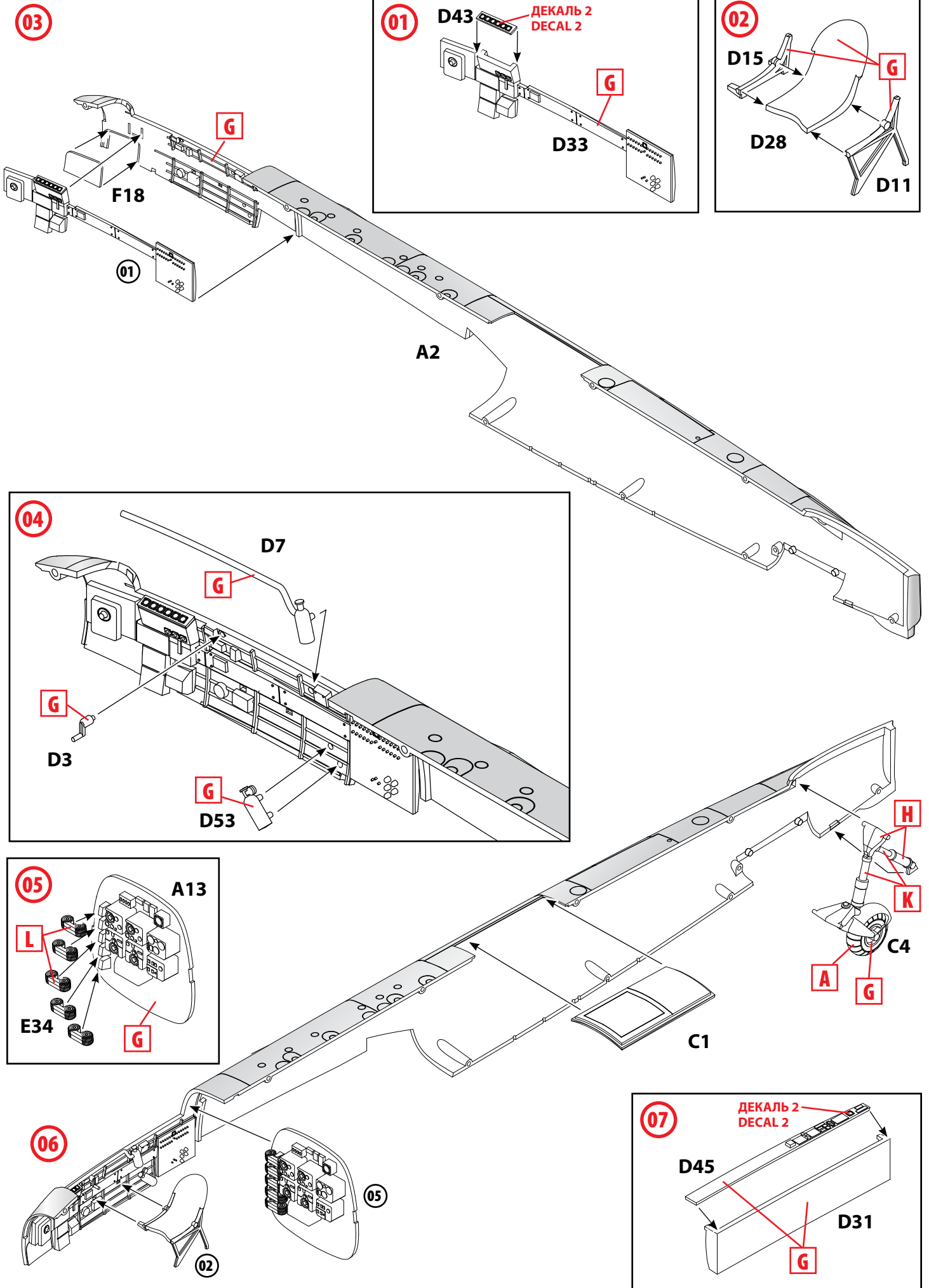

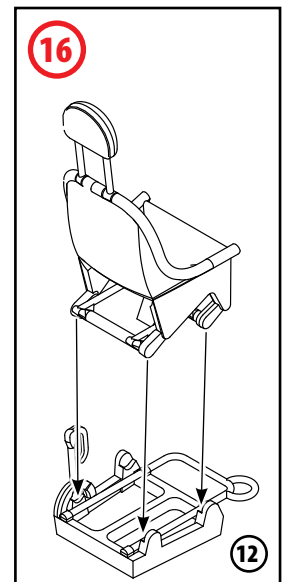
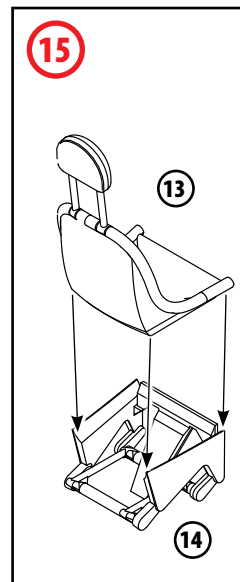
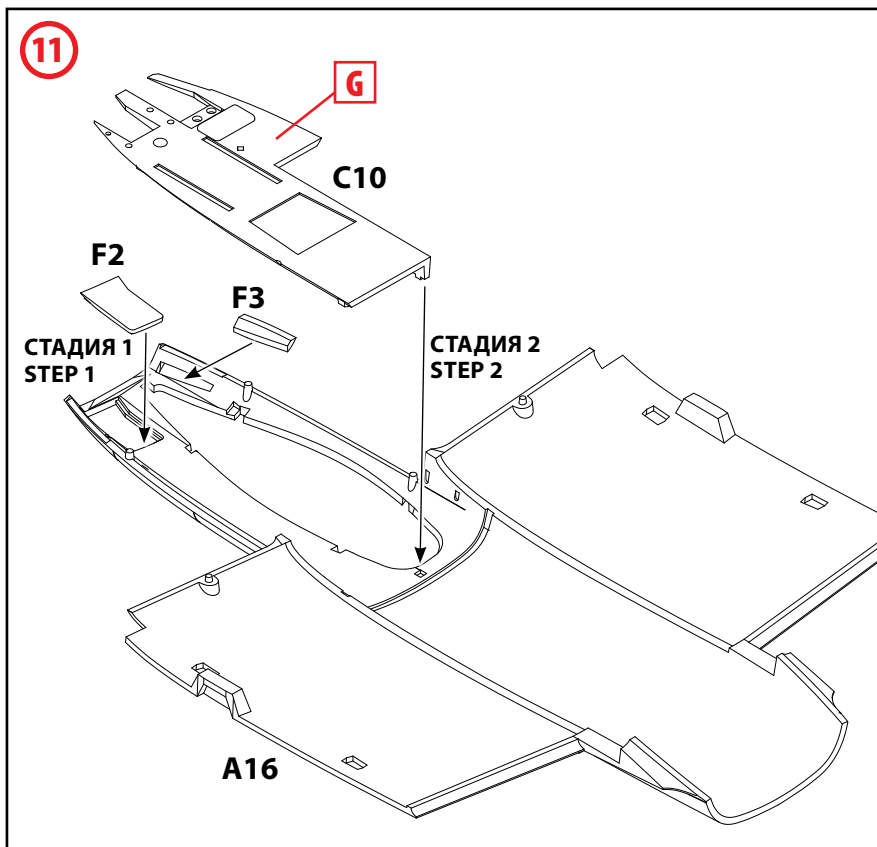
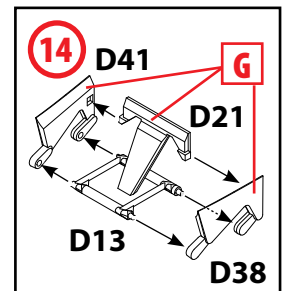
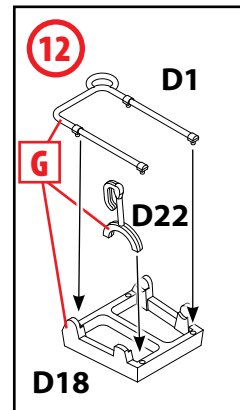
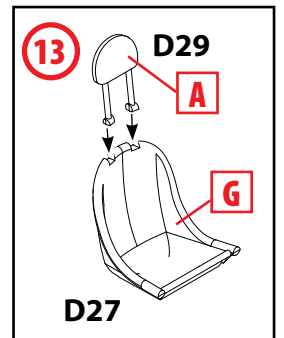
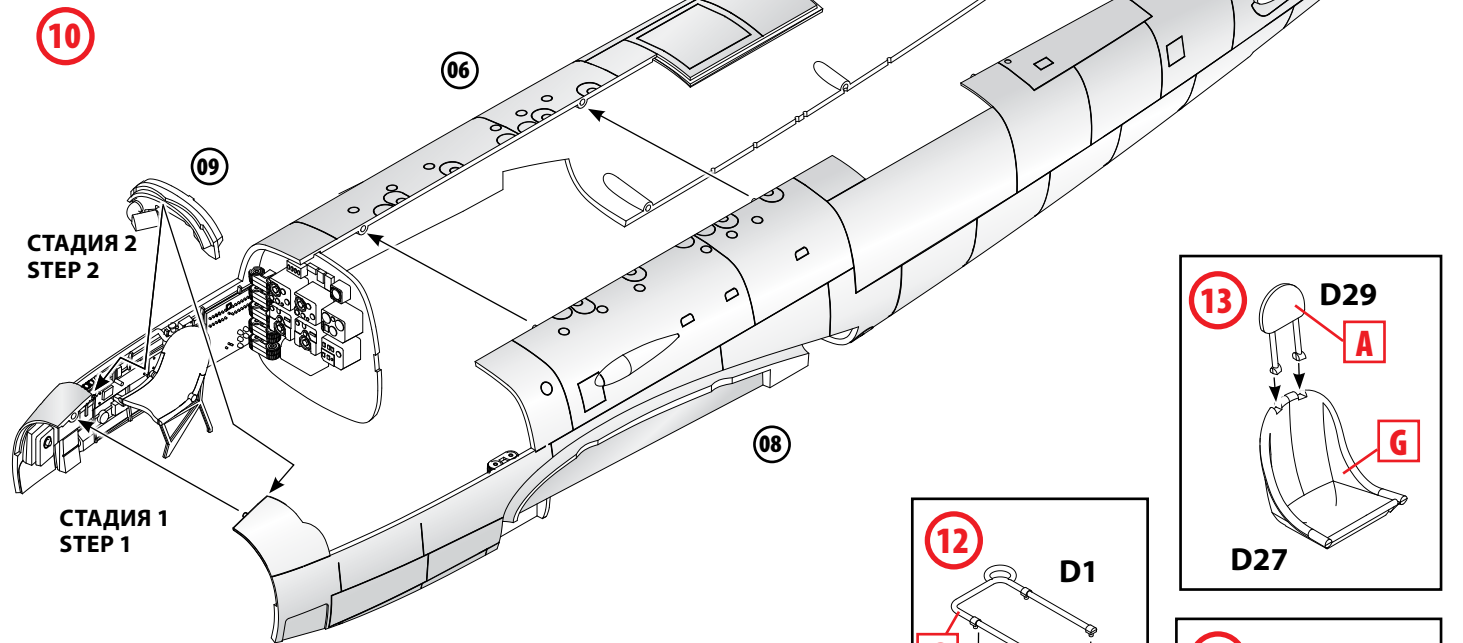
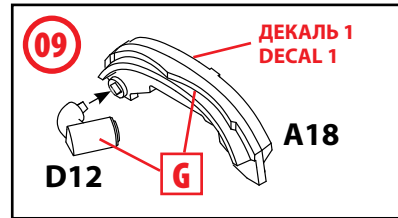
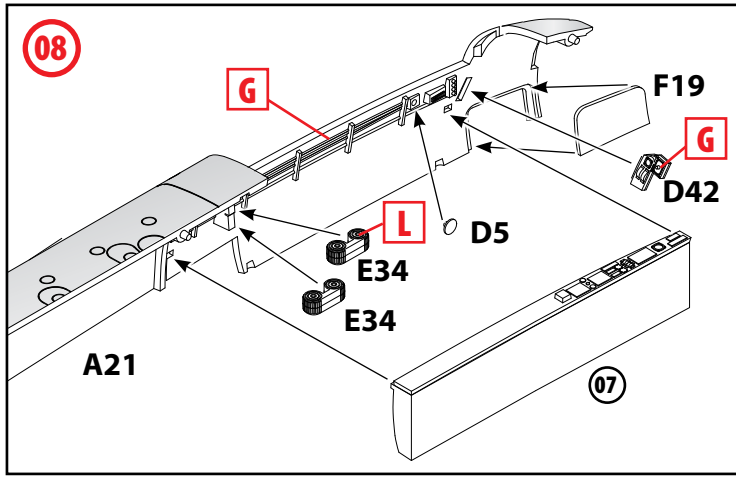

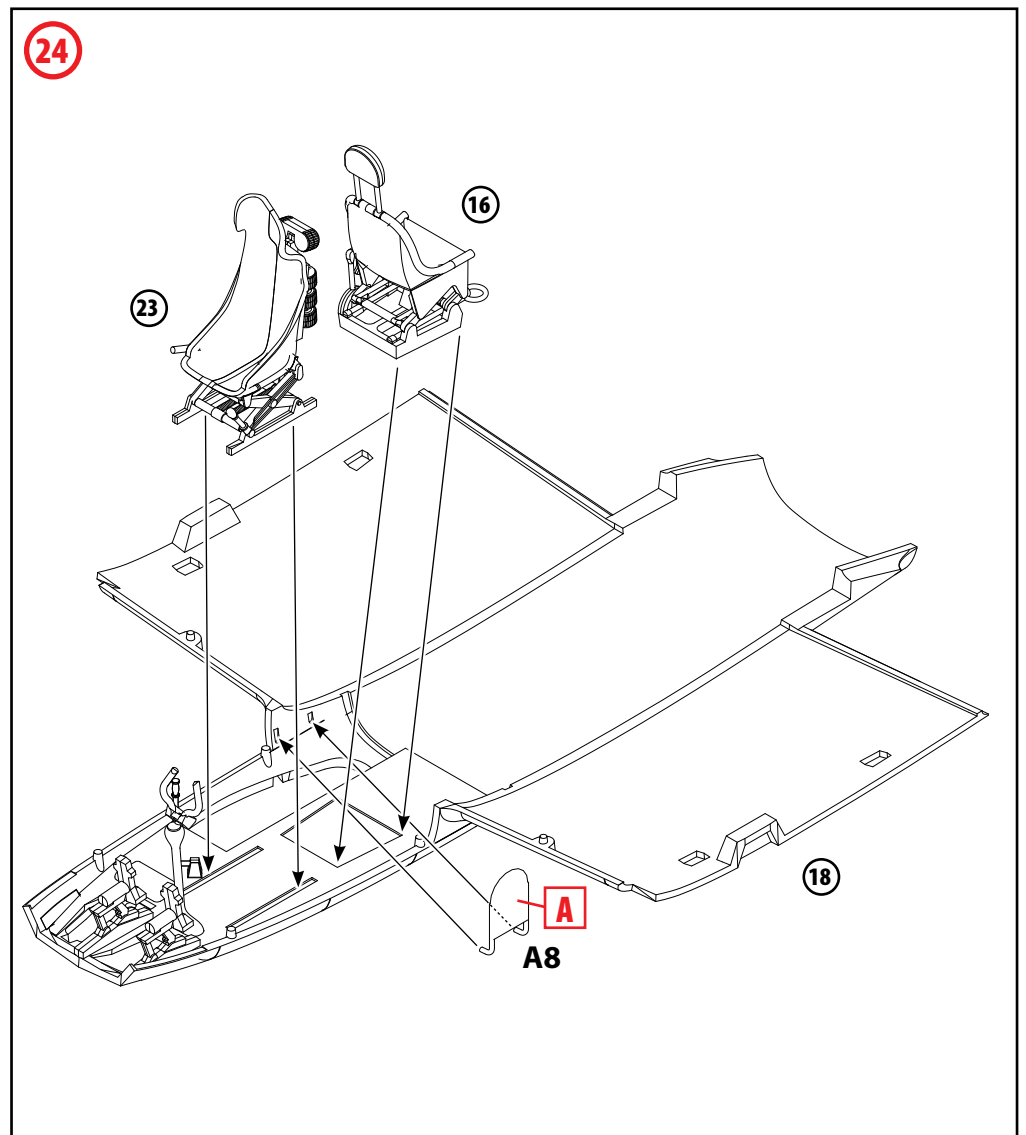
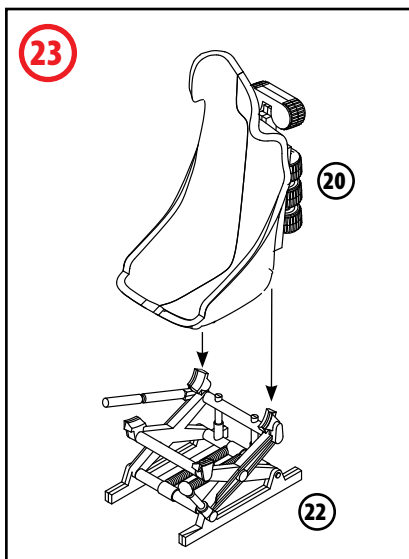
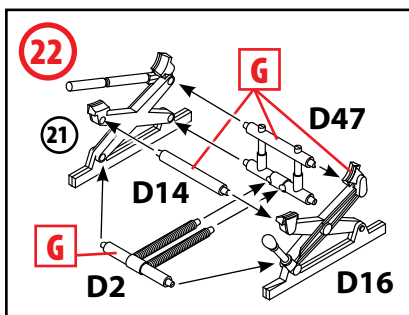
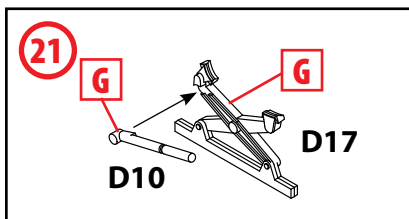
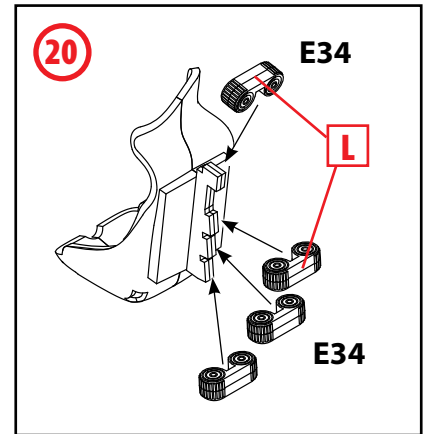
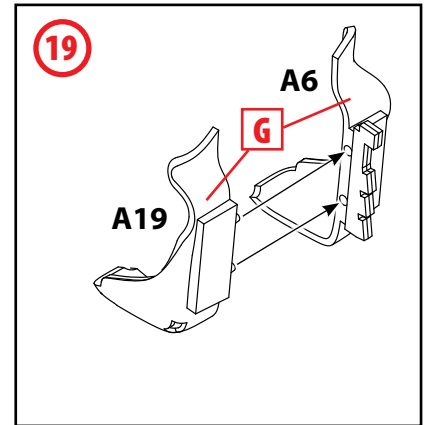
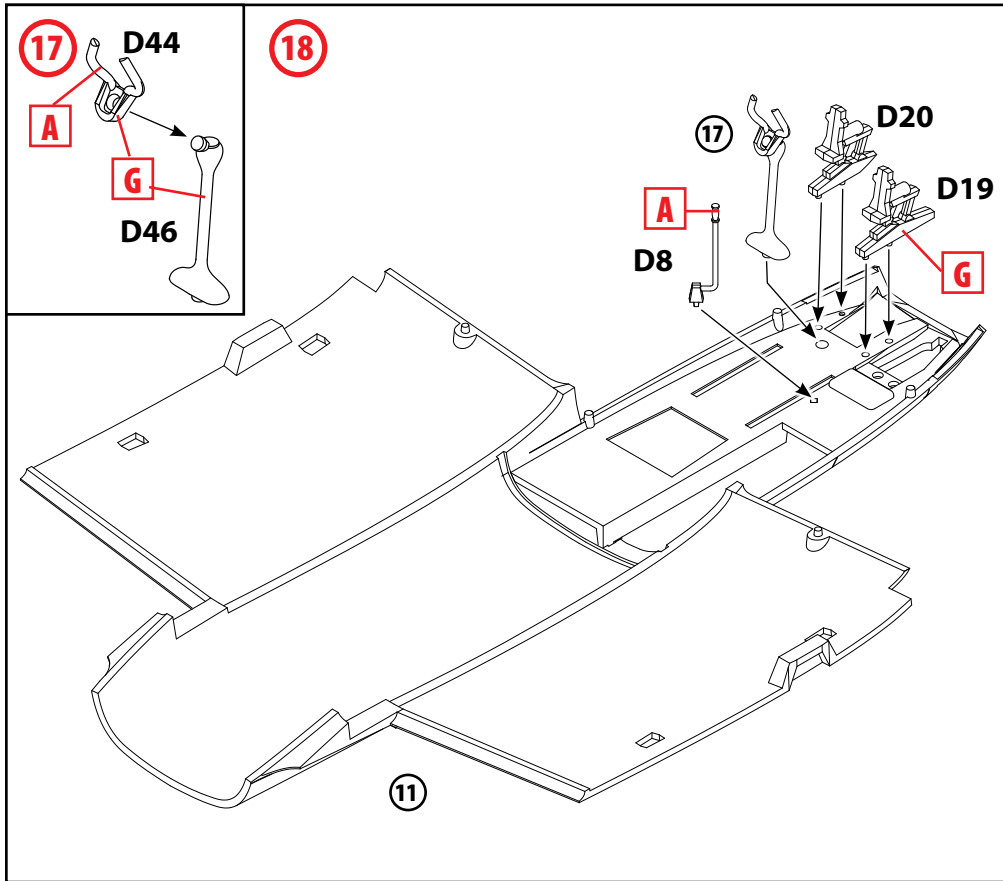

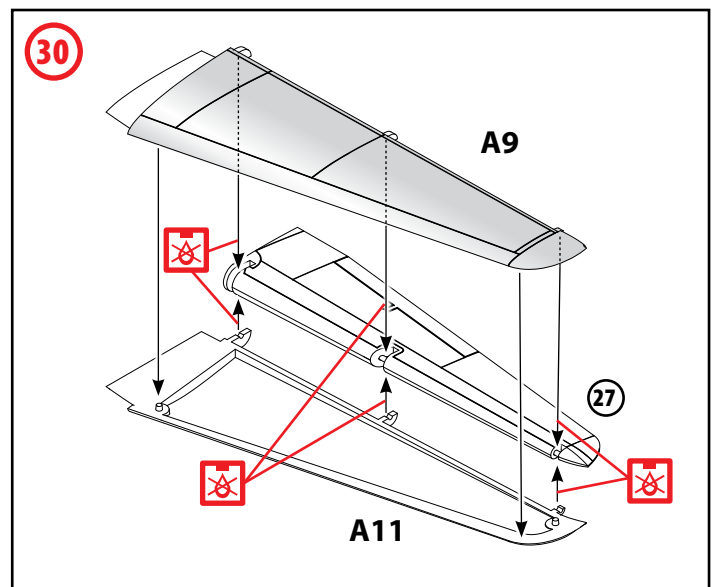
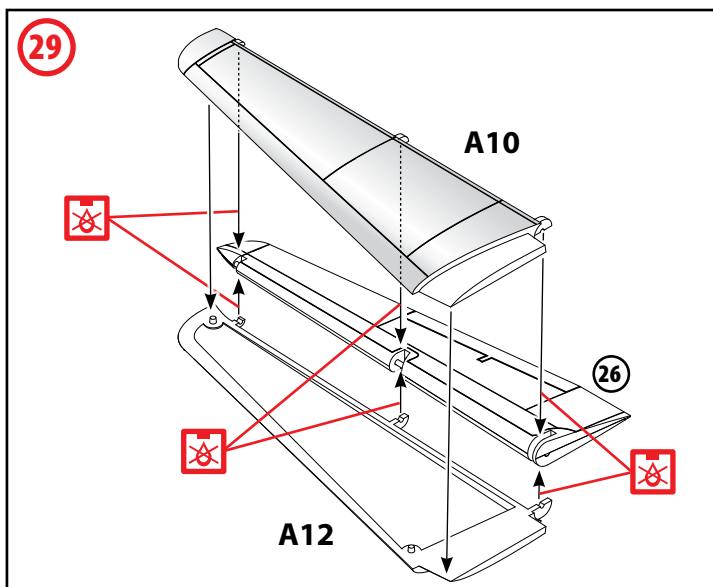
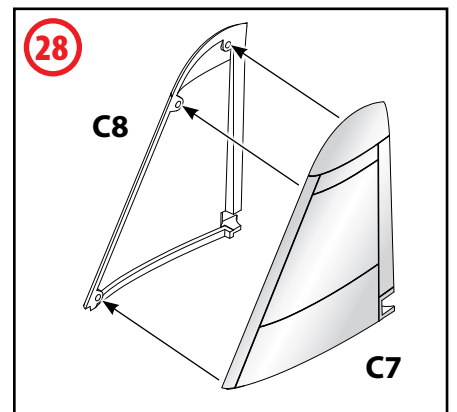
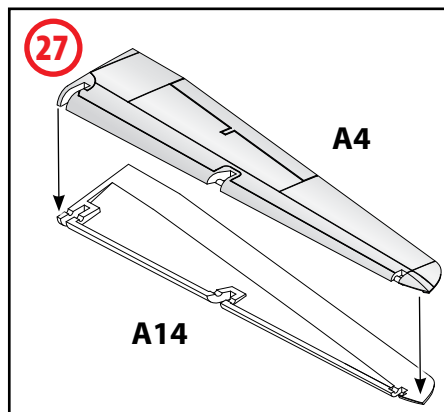
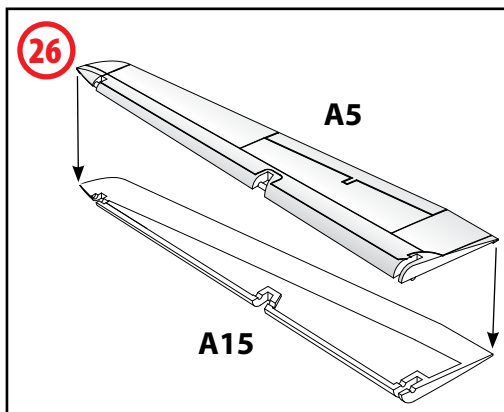
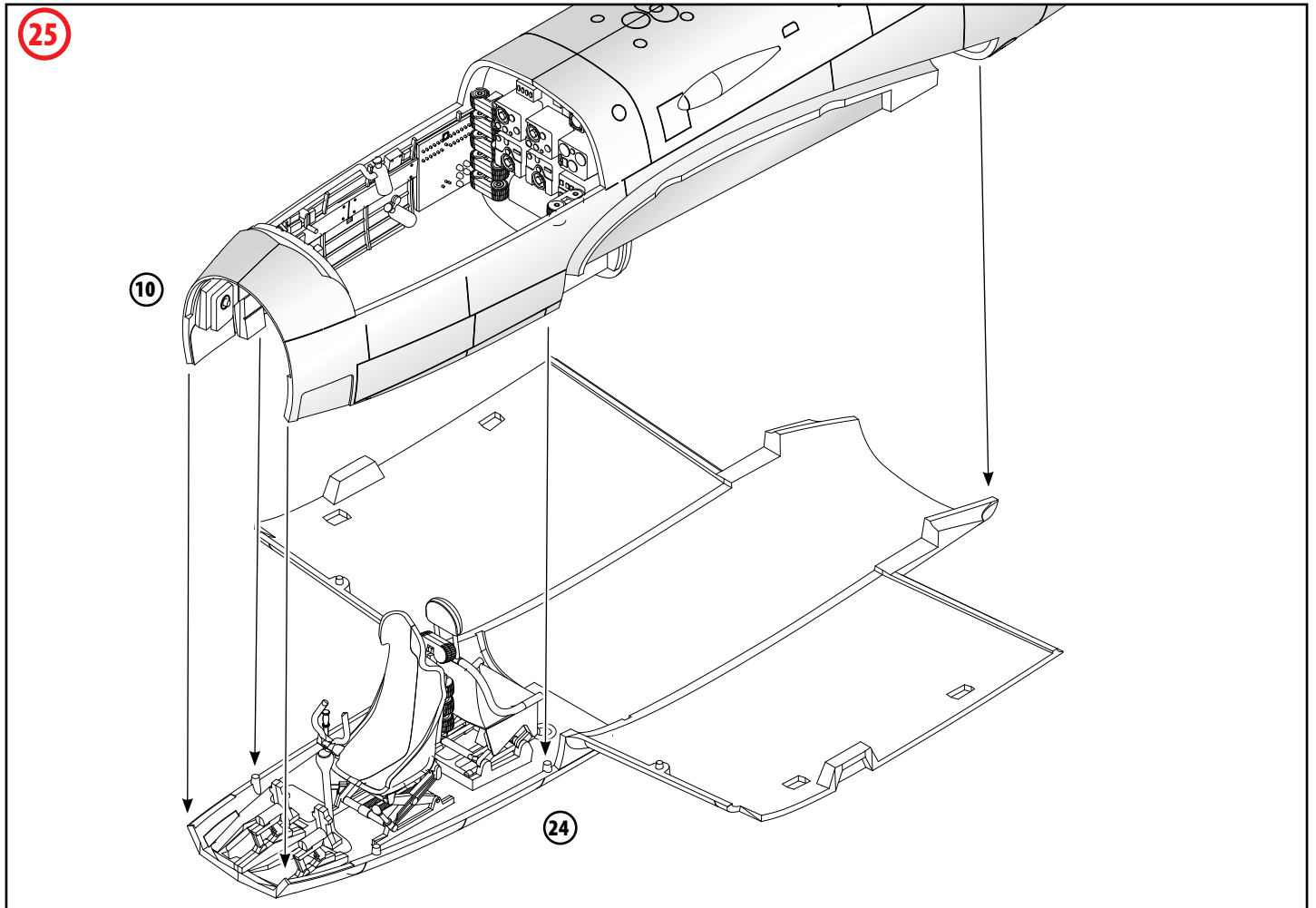

31

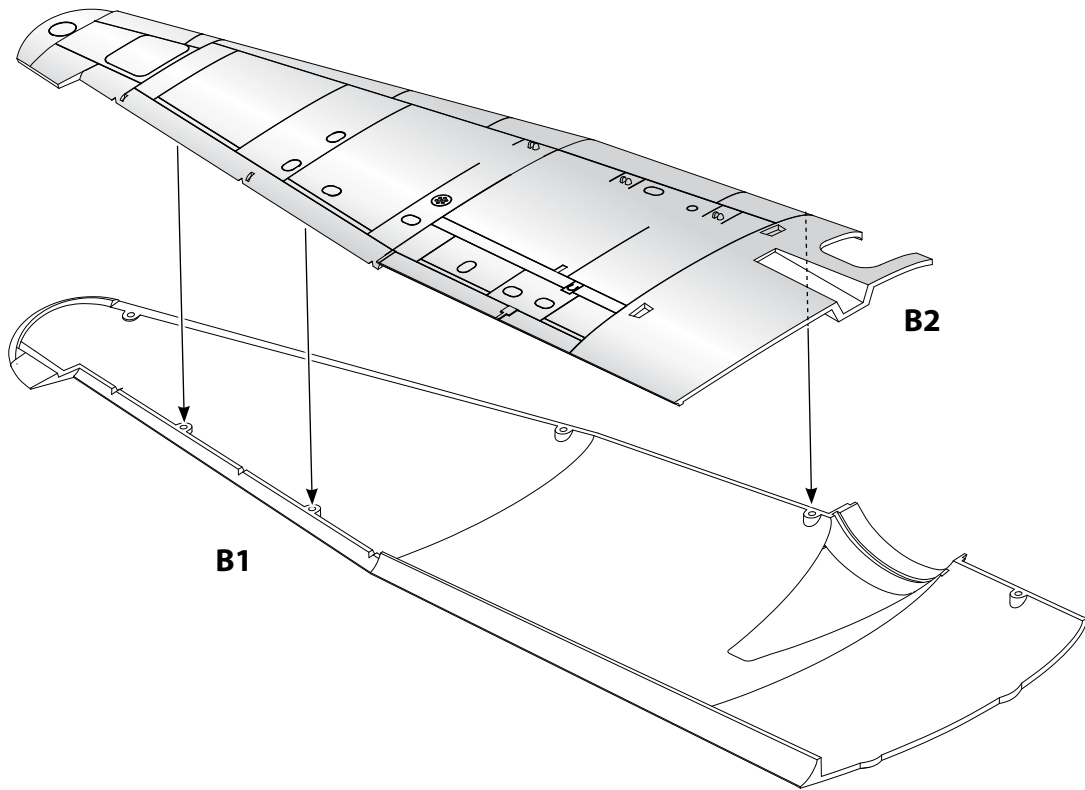

32

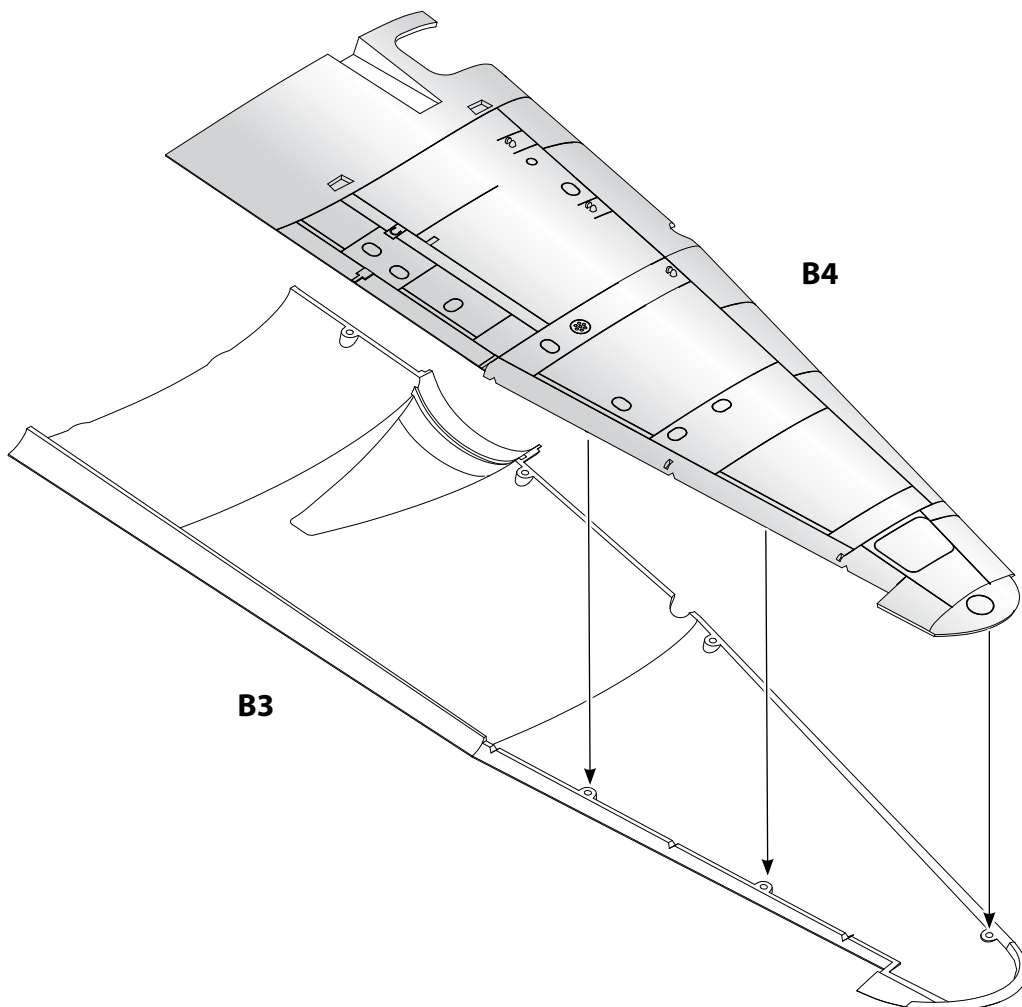

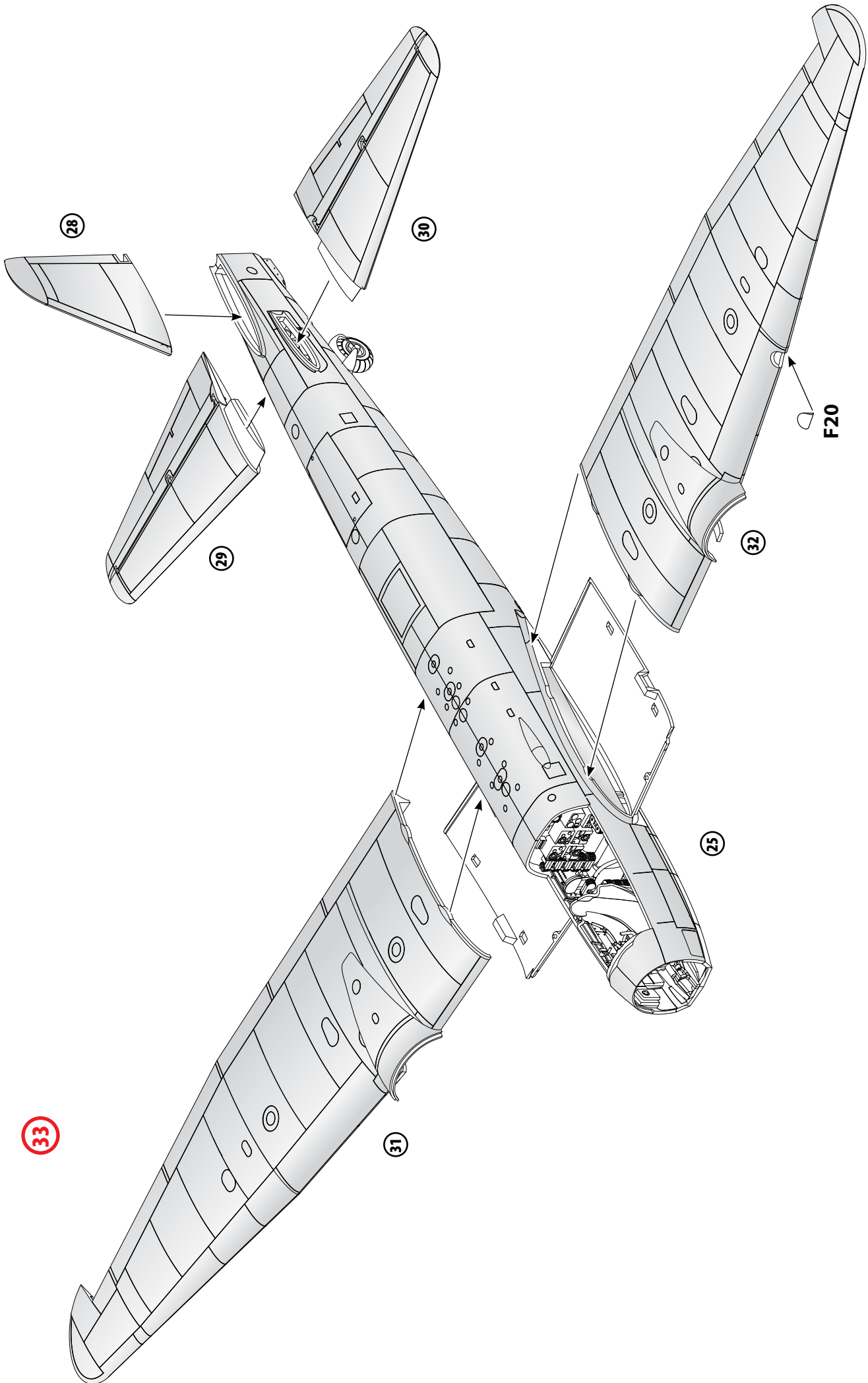

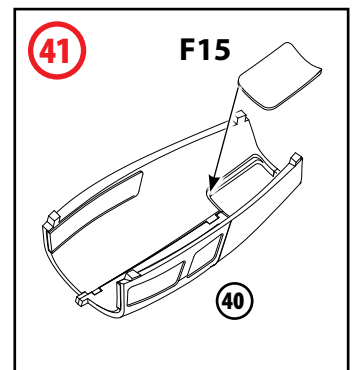
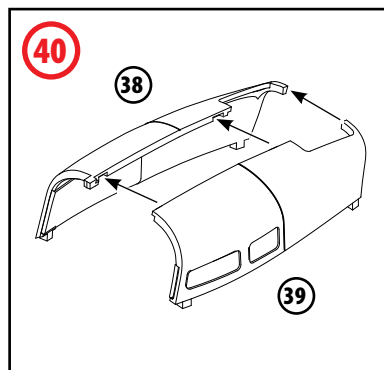
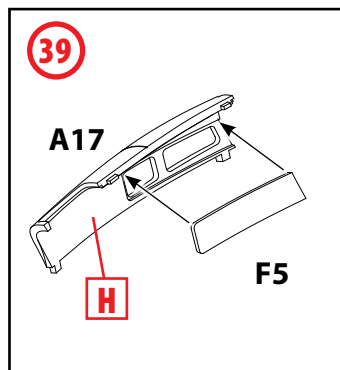
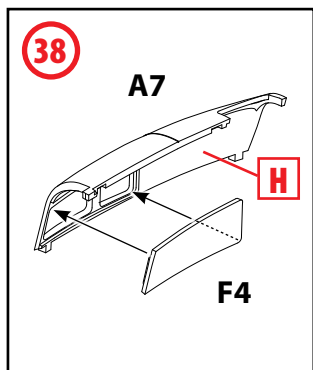
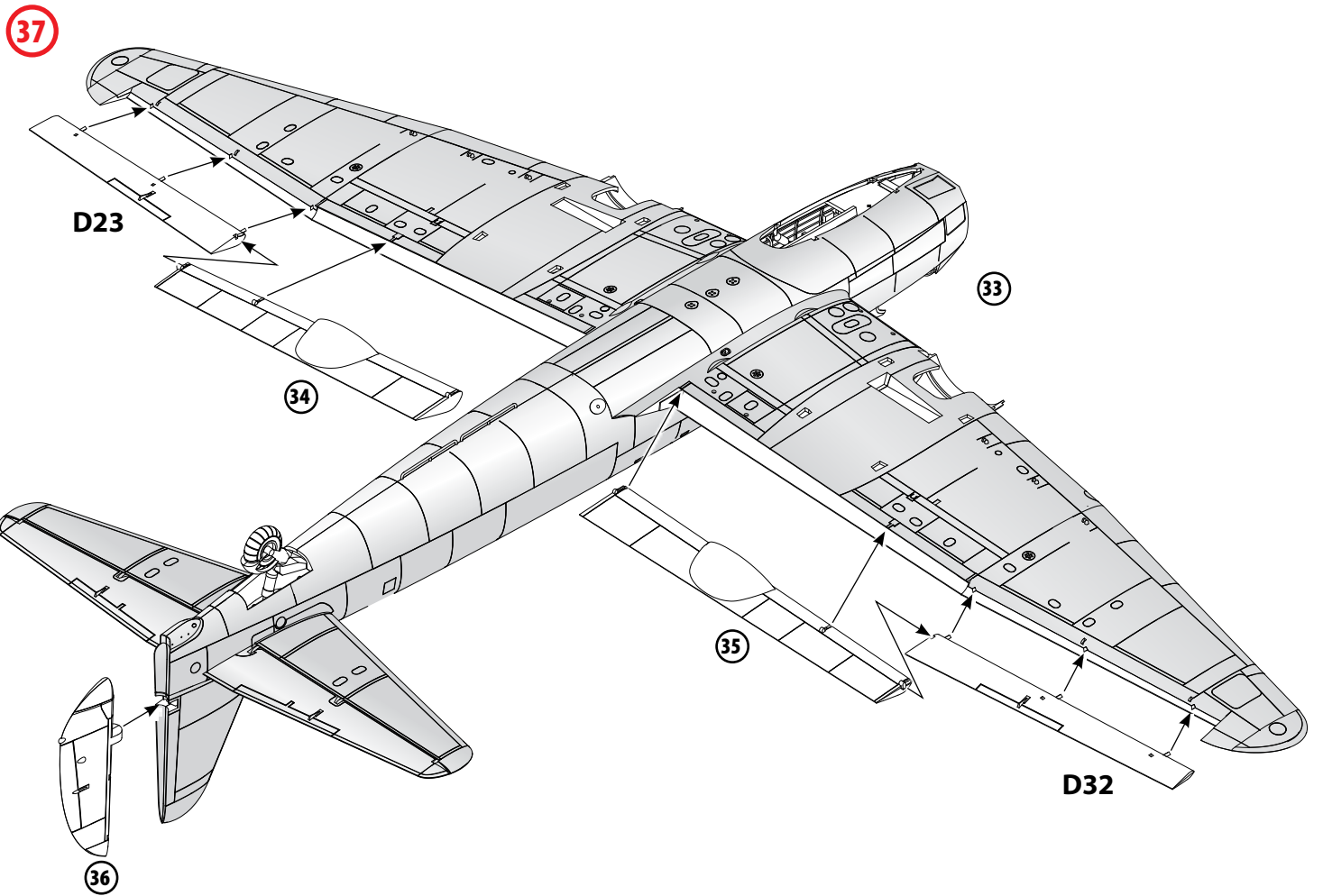
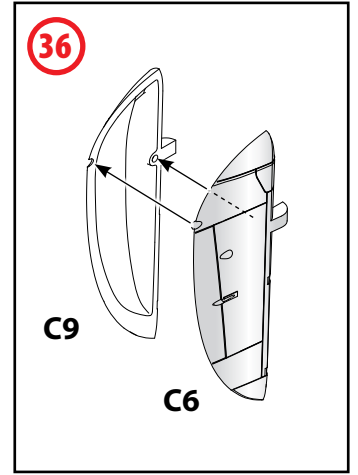
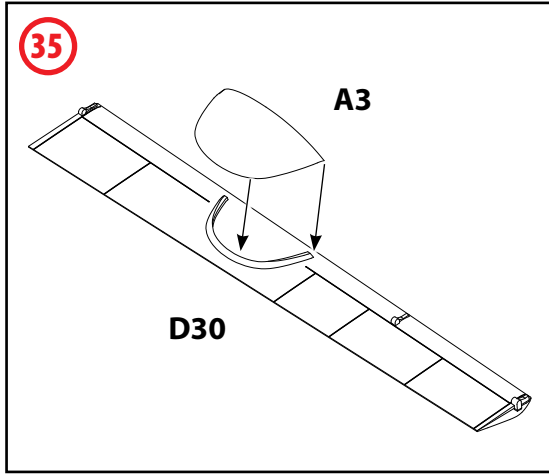
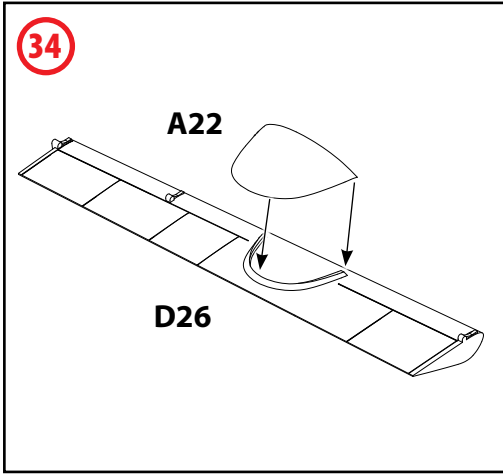

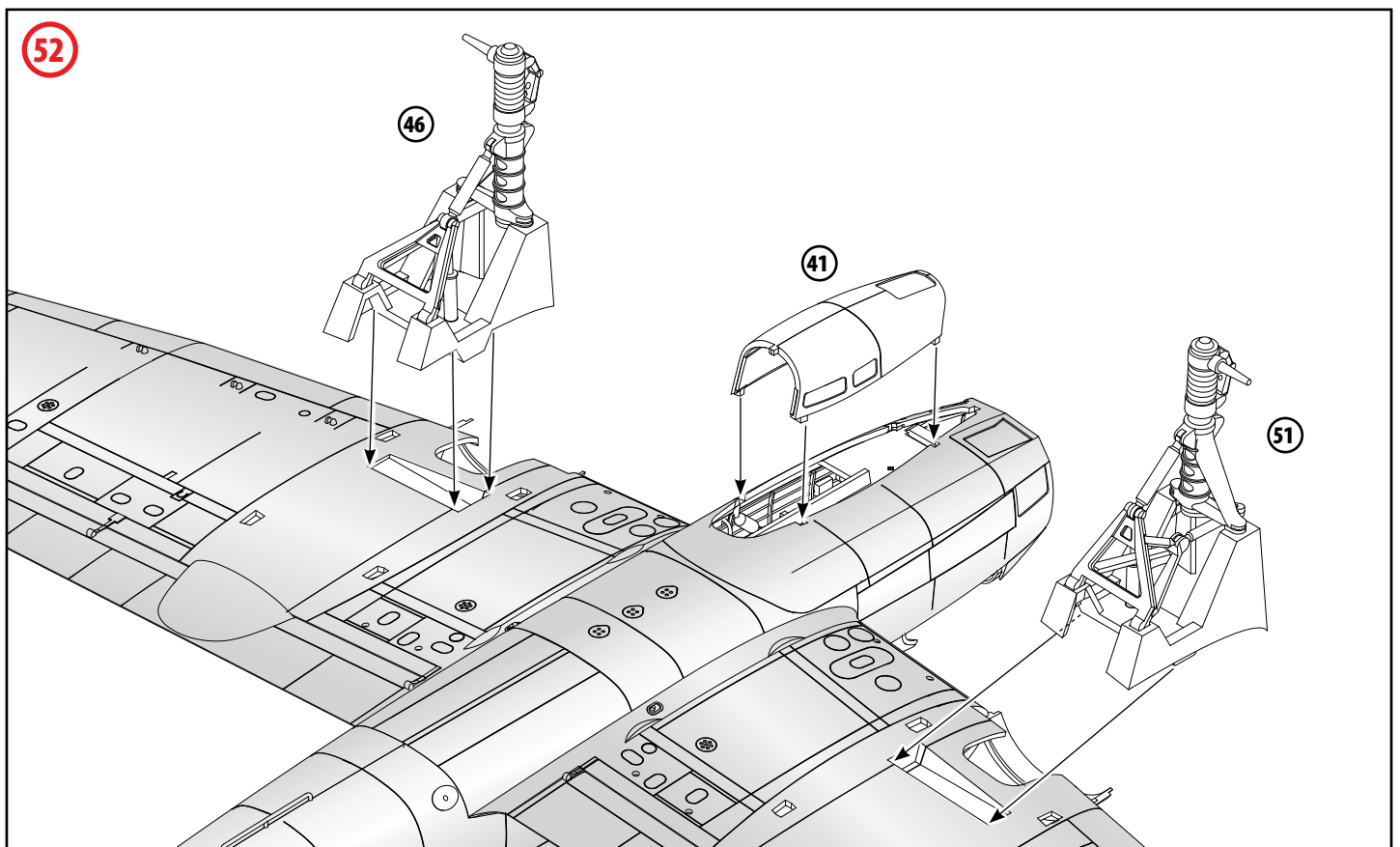
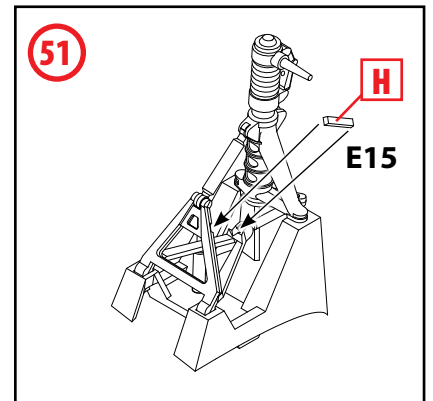
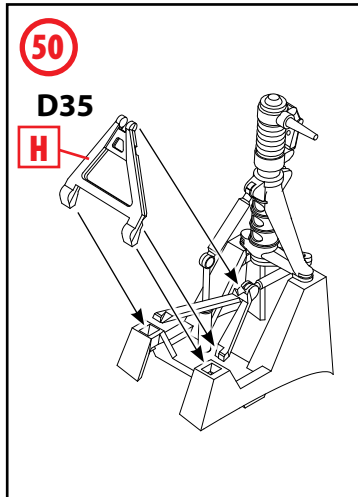
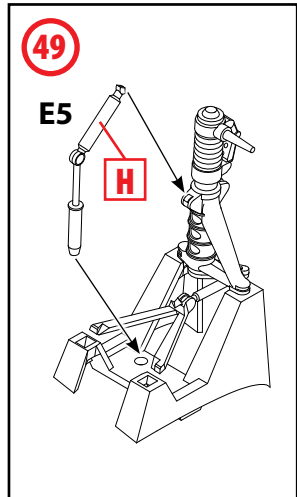
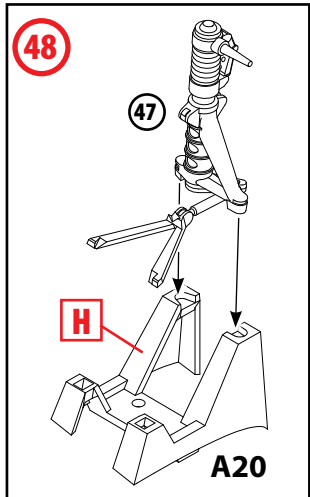
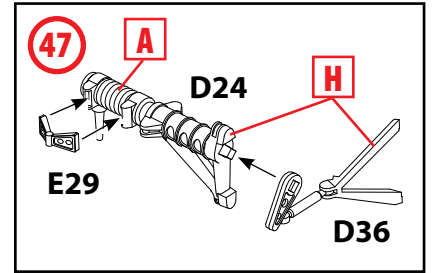
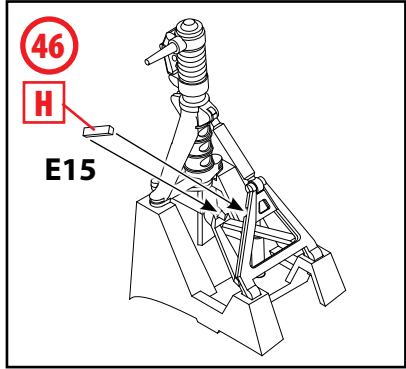
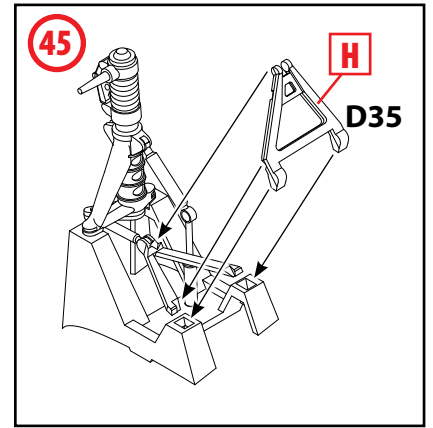
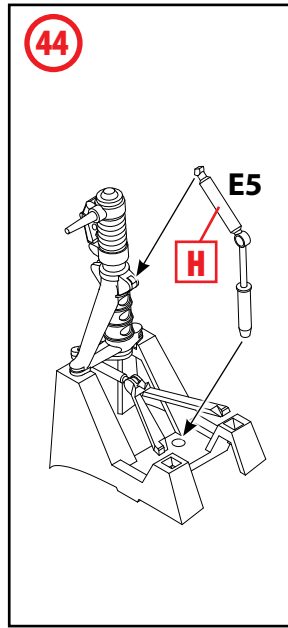
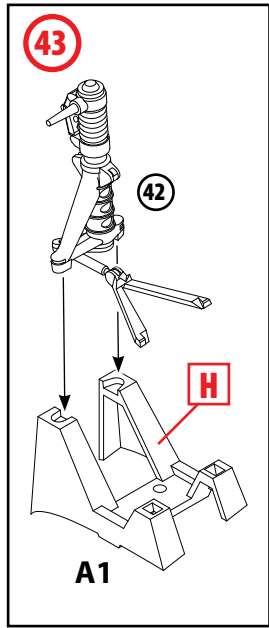
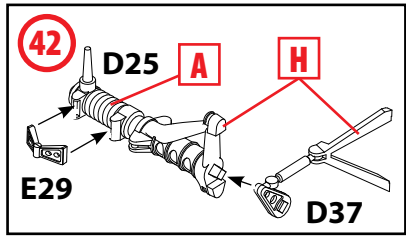

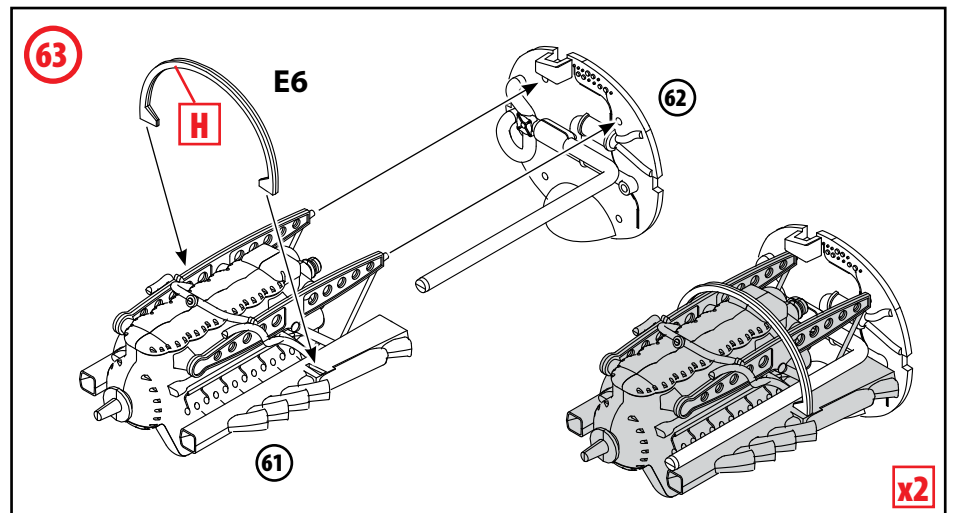
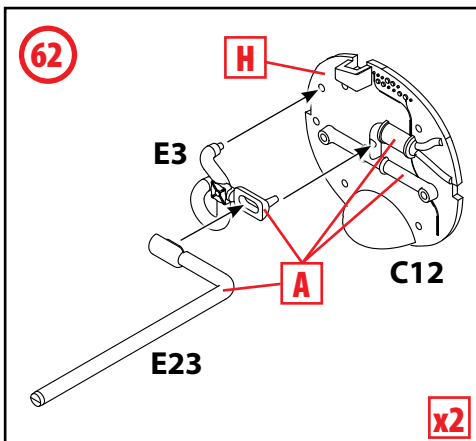
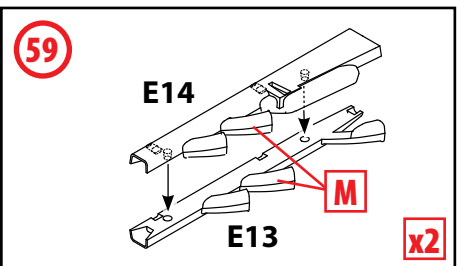
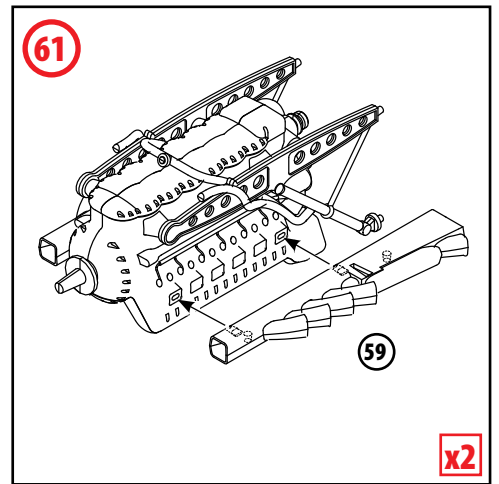
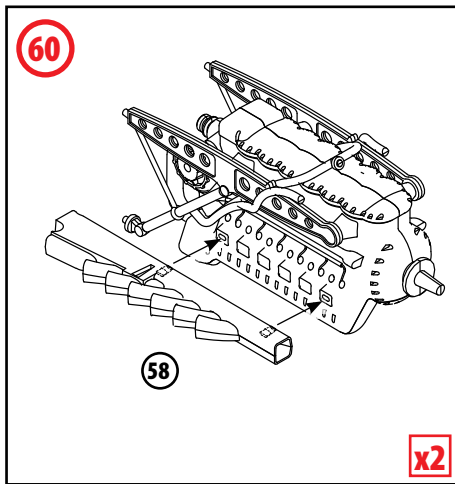
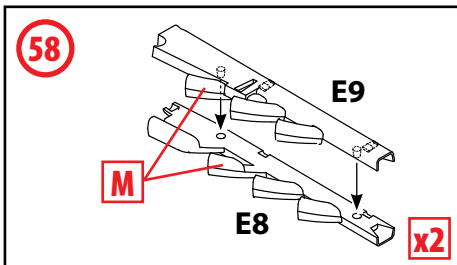
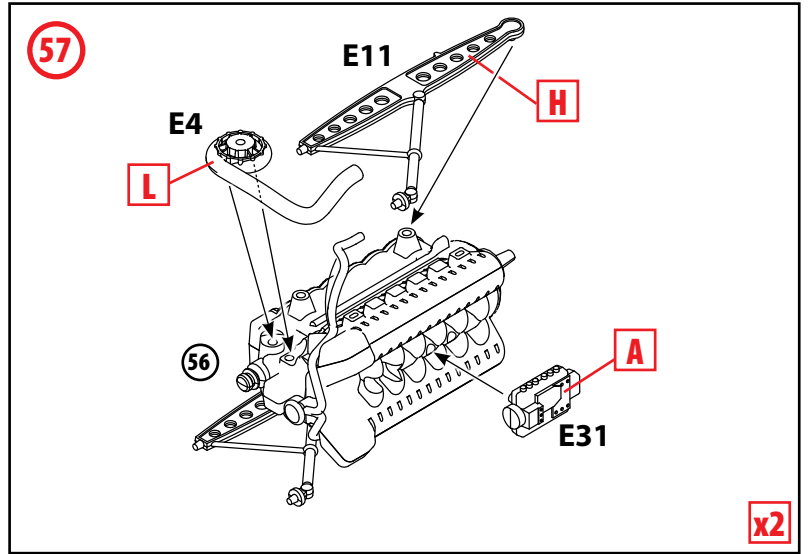
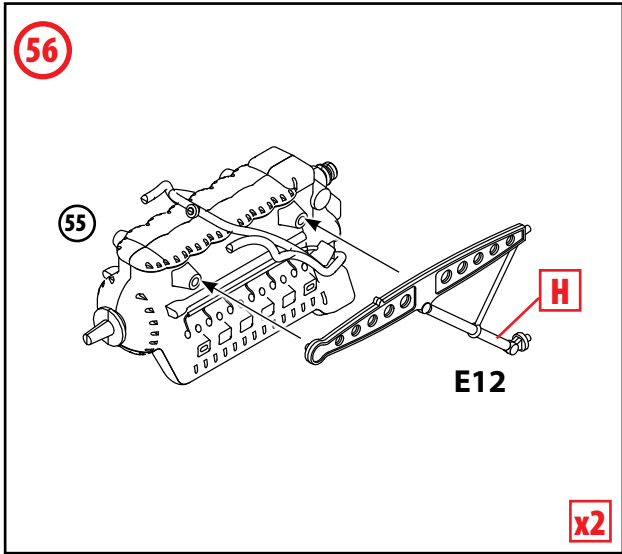
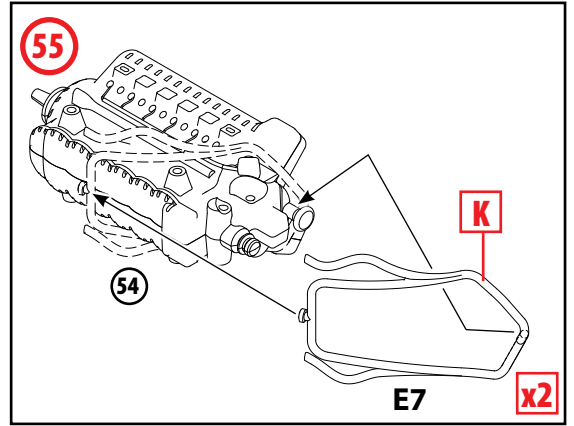
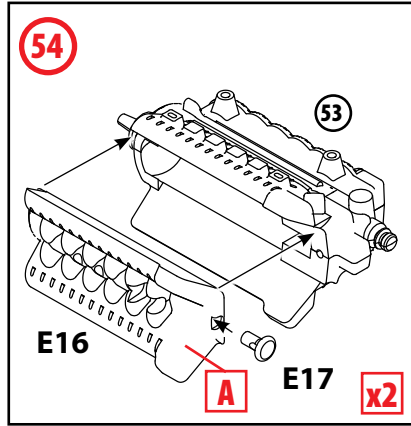
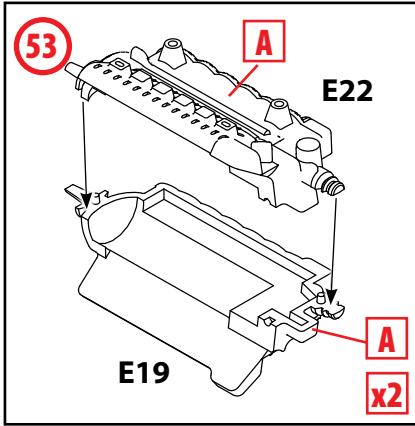

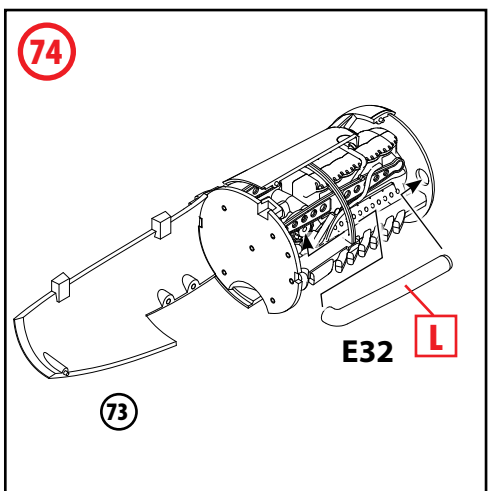
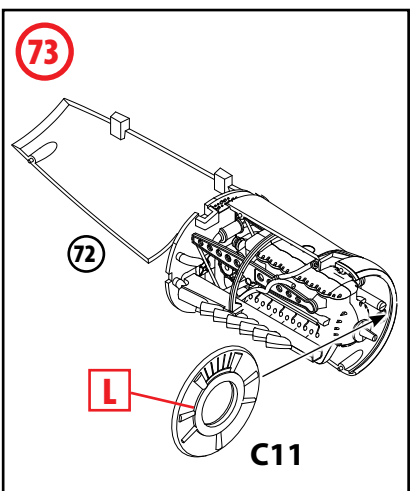
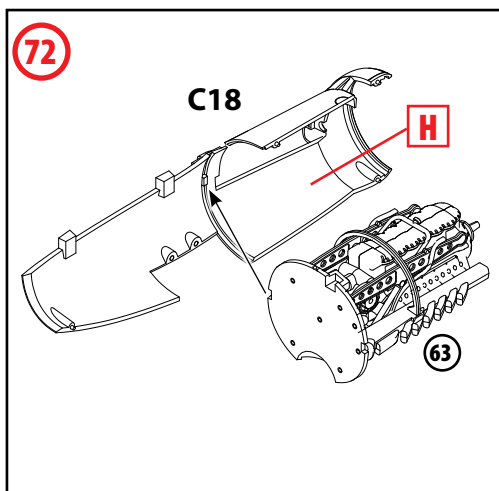
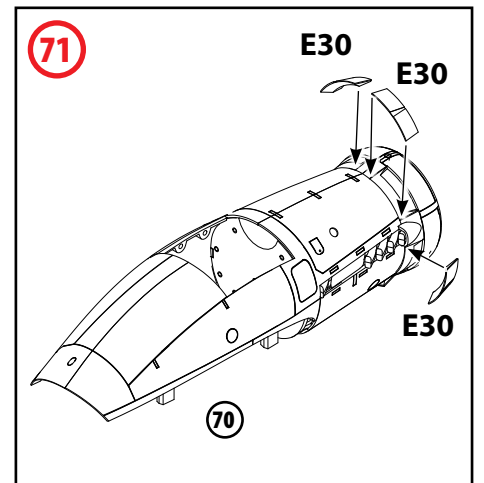
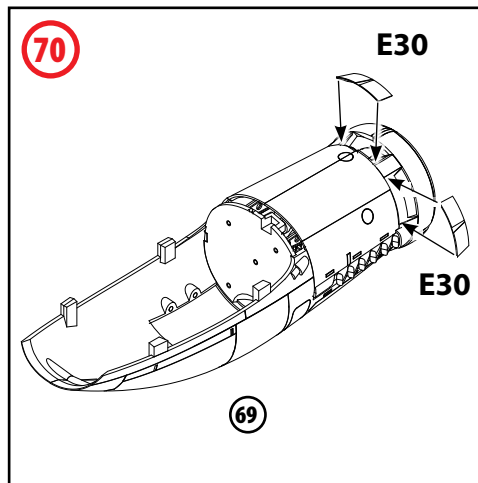
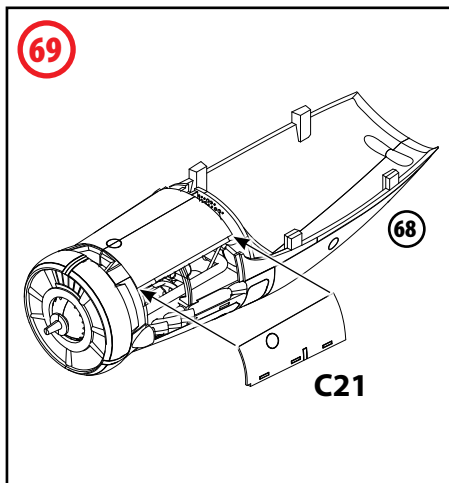
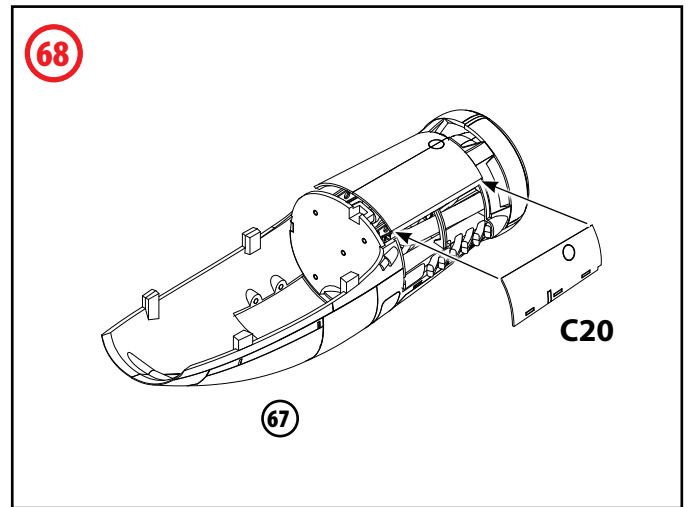
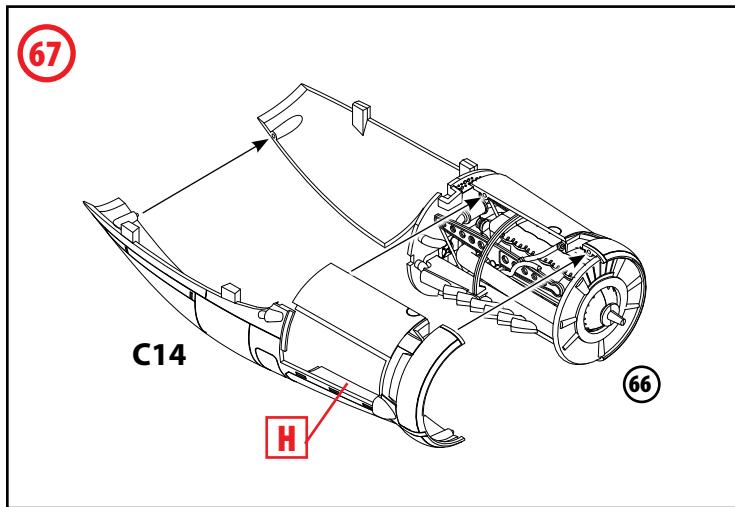
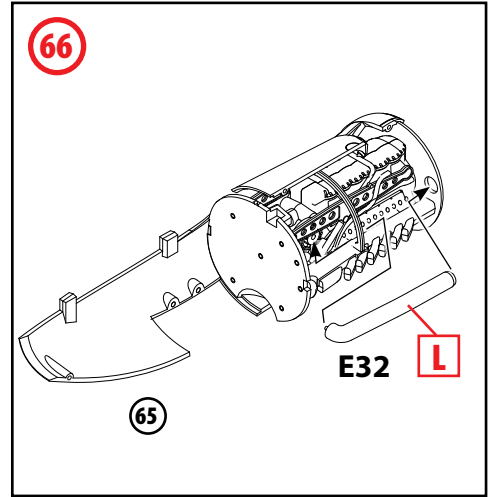
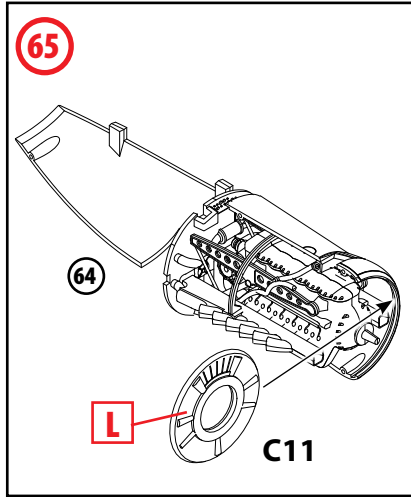
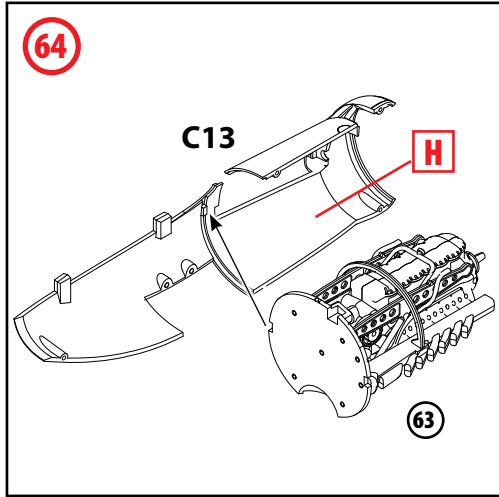

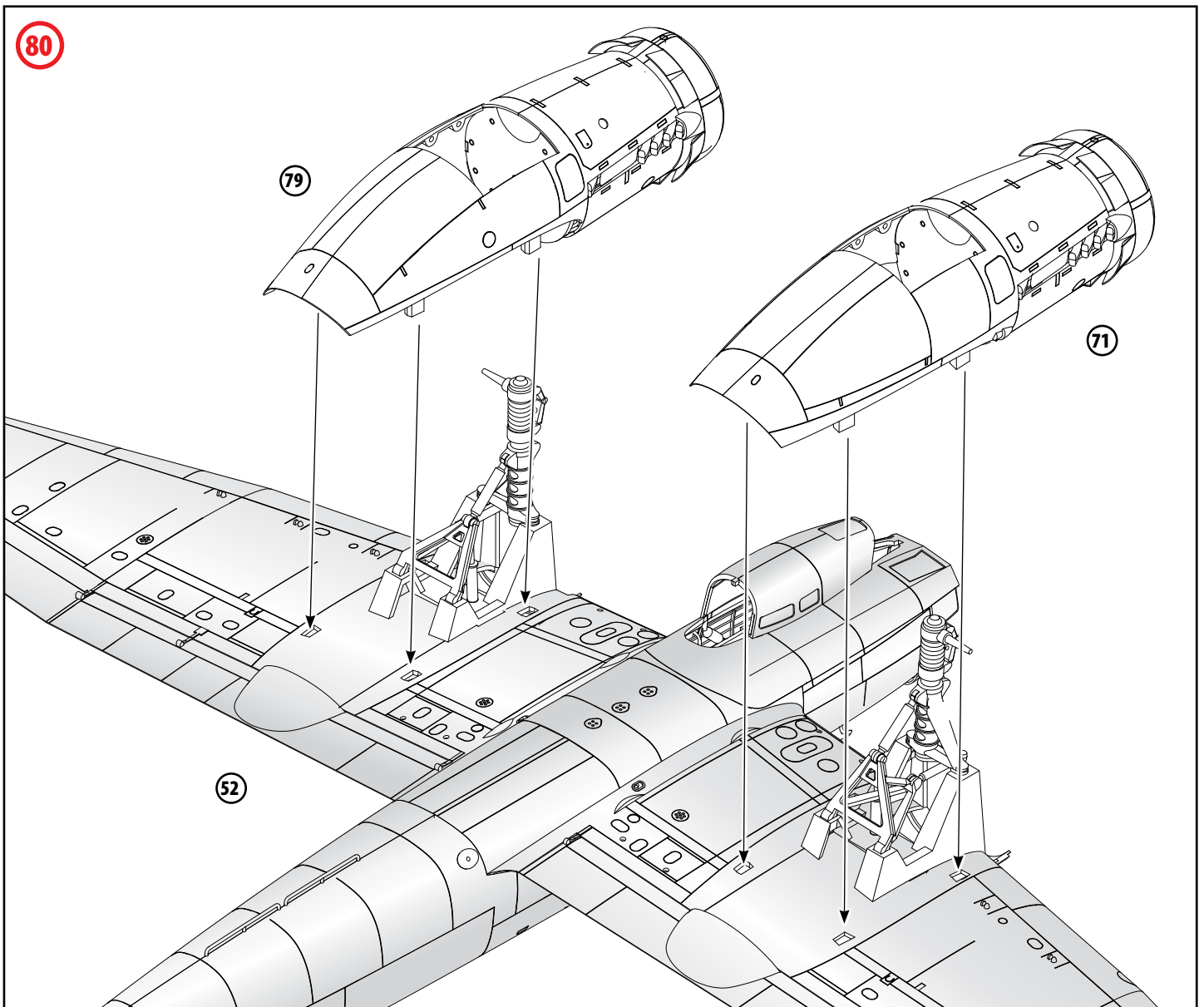
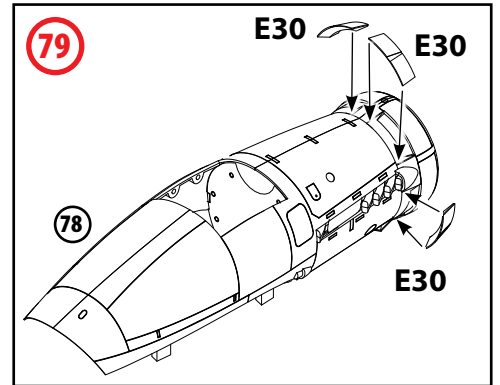
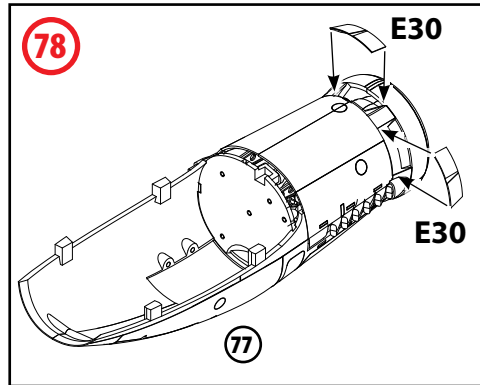
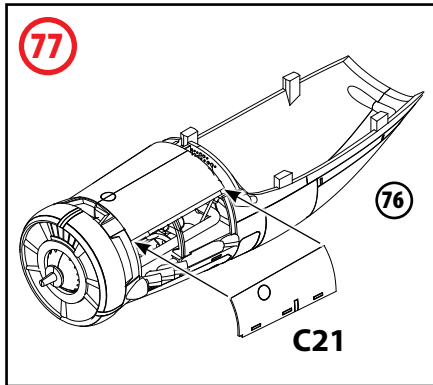
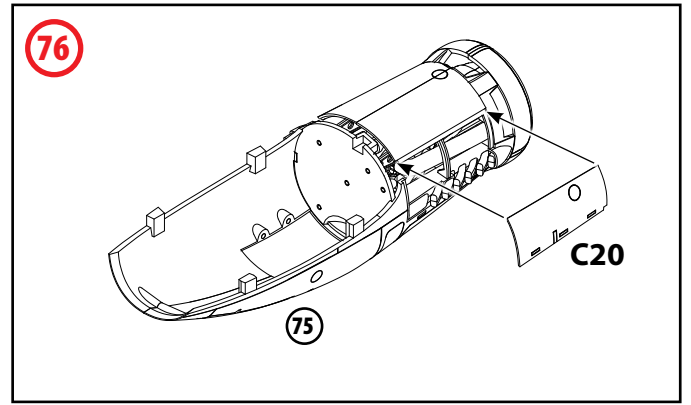
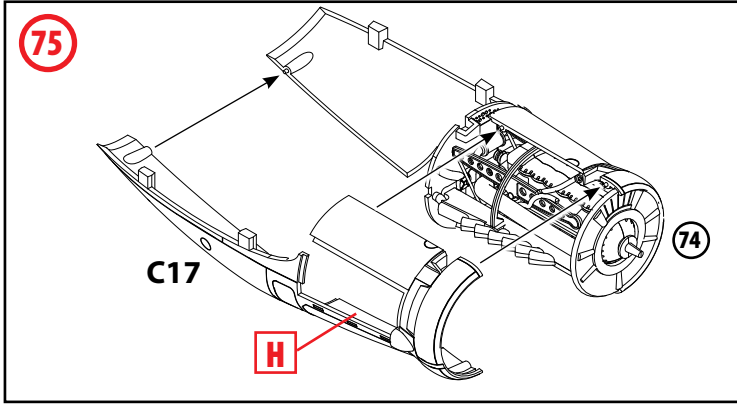

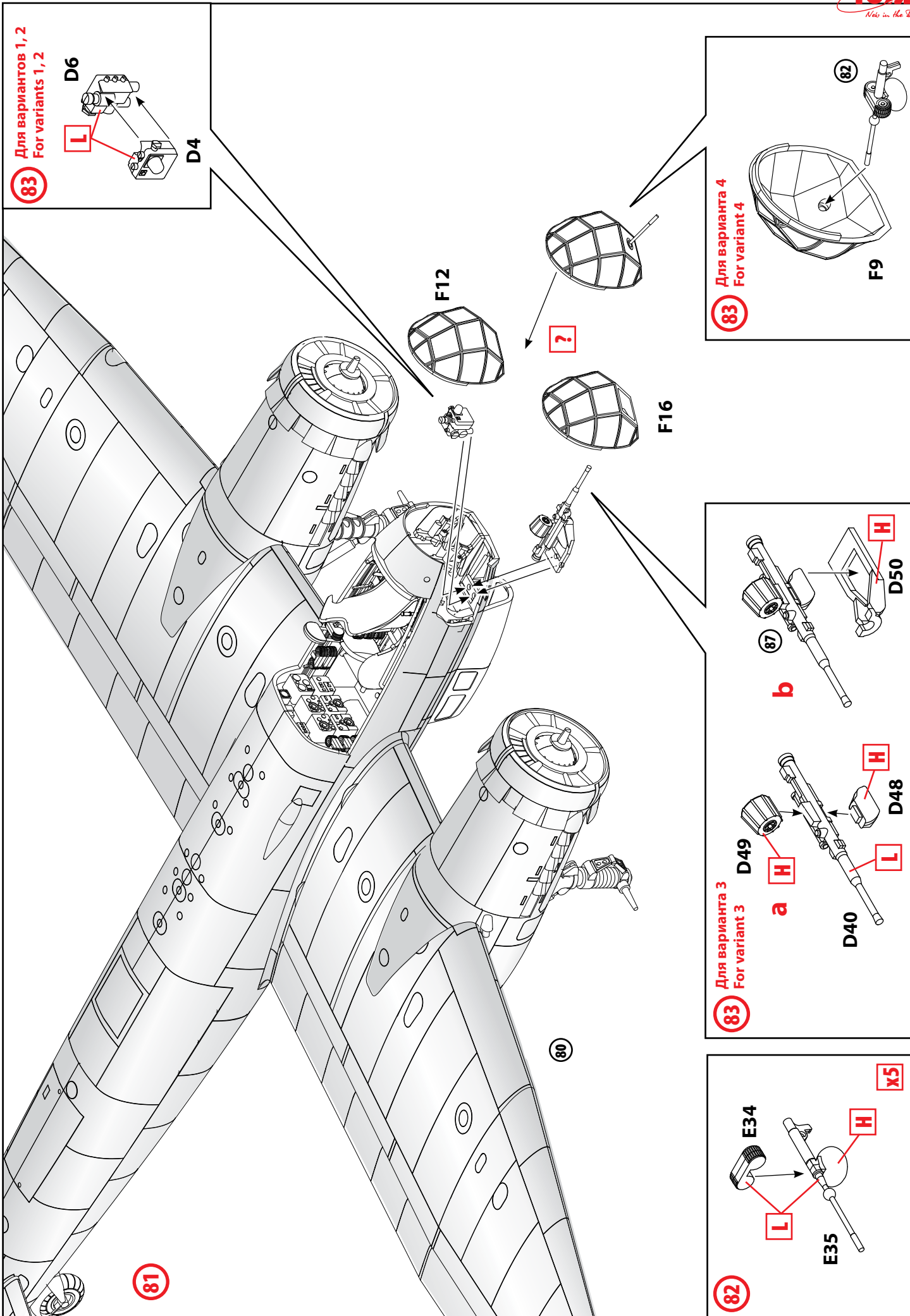

83 Для вариантов 1, 2
For variants 1, 2

D6

L

D4

83 Для варианта 4
For variant 4

F9

82

83 Для варианта 3
For variant 3

D49

D40

D48

D50

L

H

H

a

b

82

E34

E35

L

H

x5

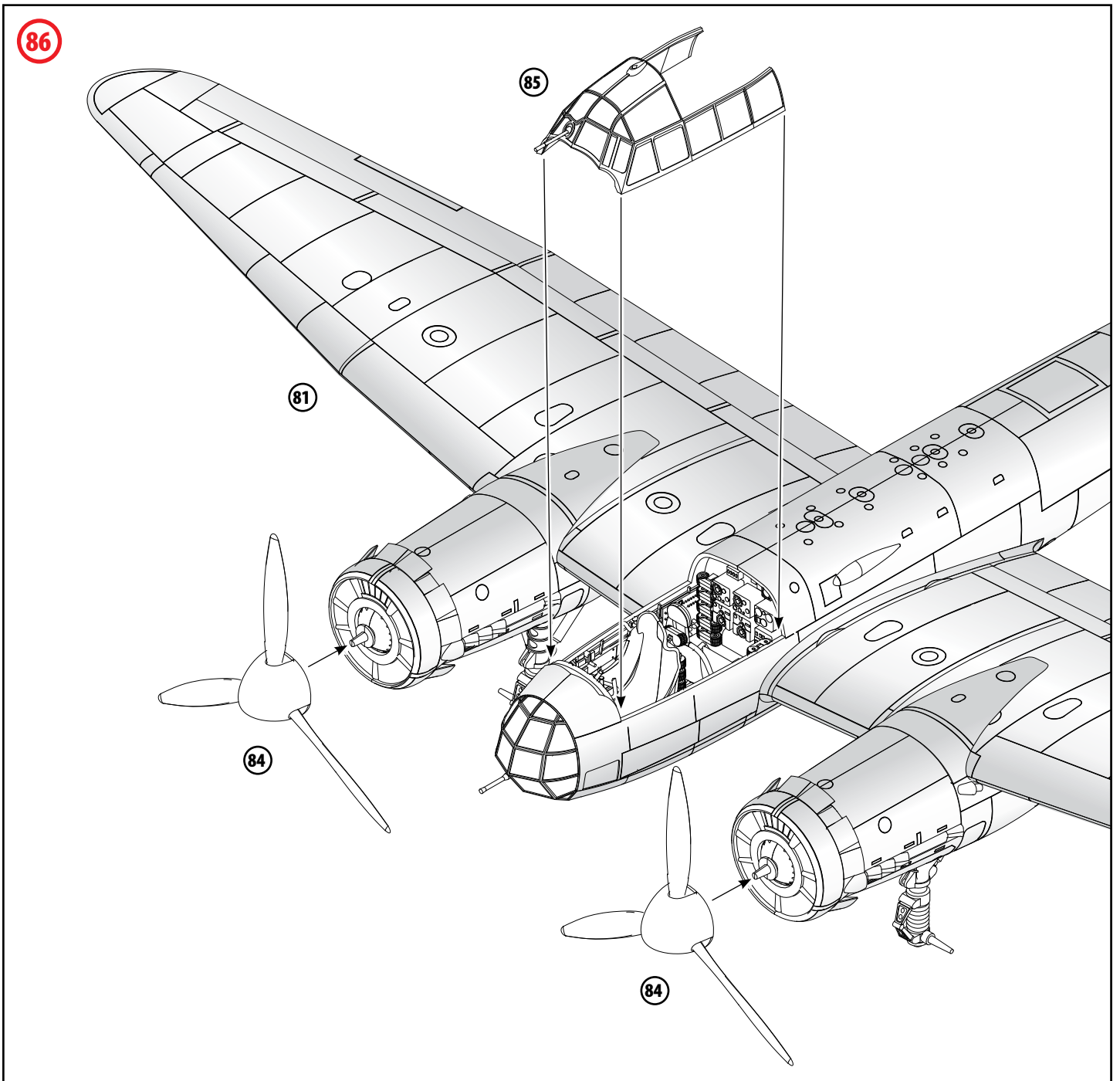
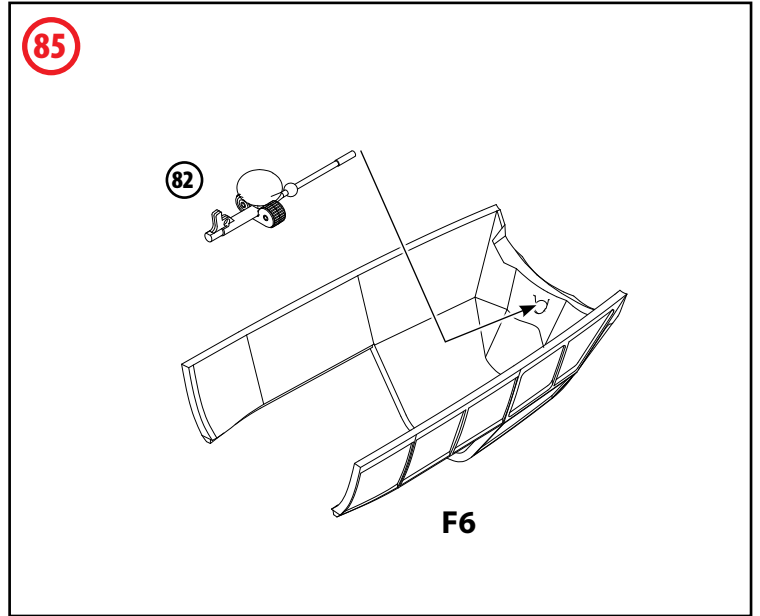
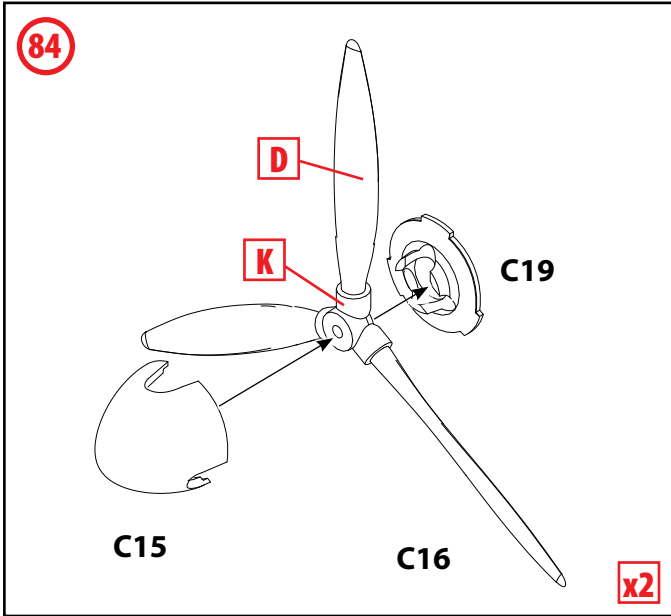

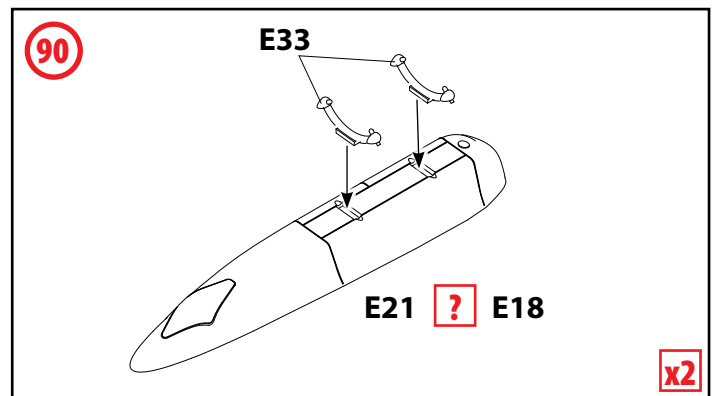
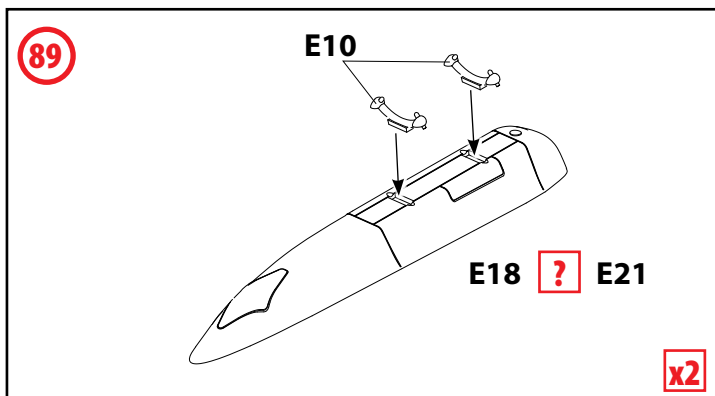
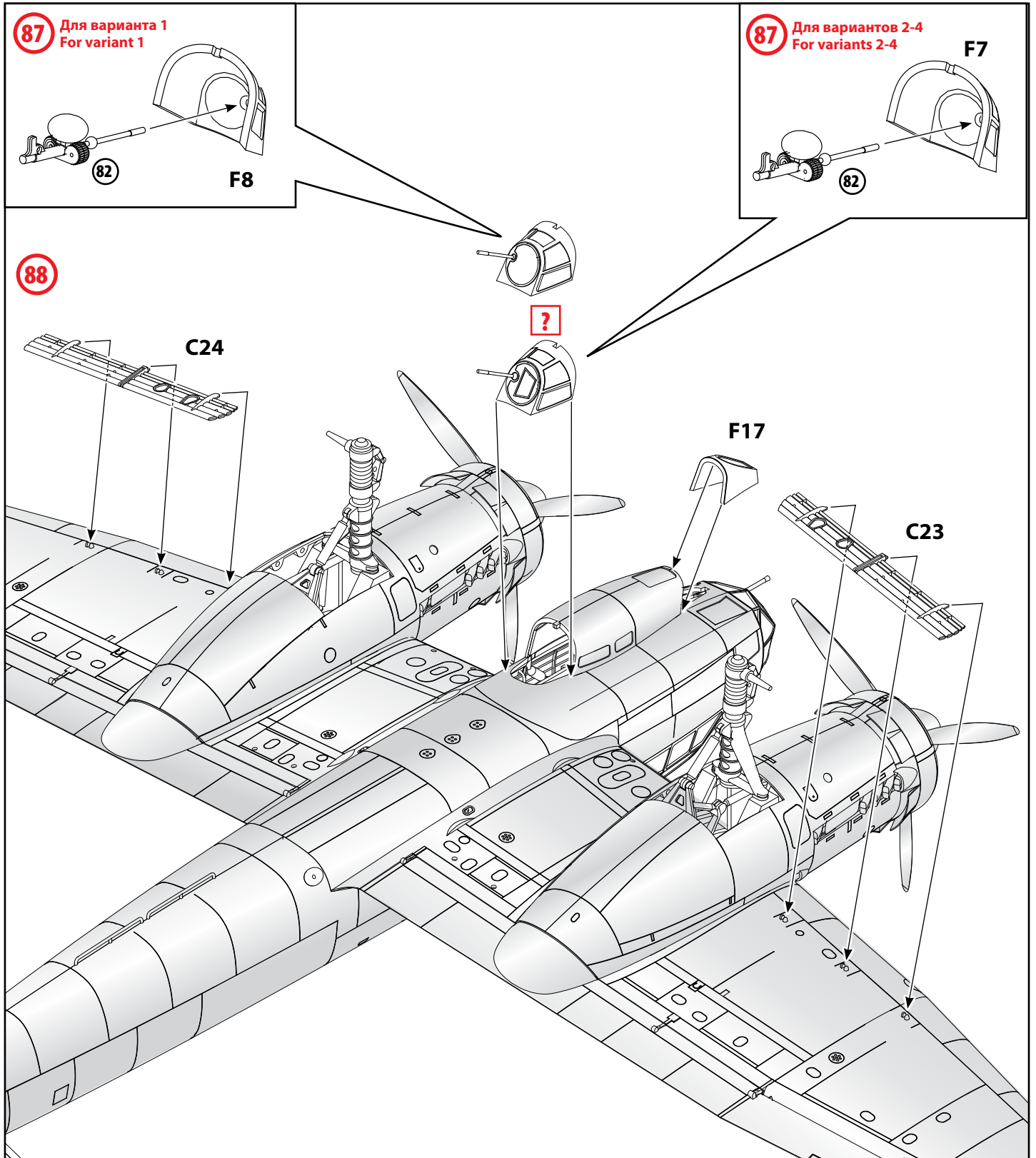

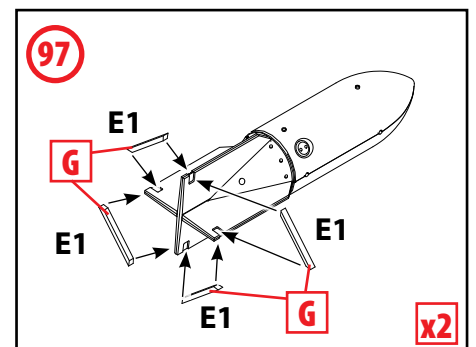
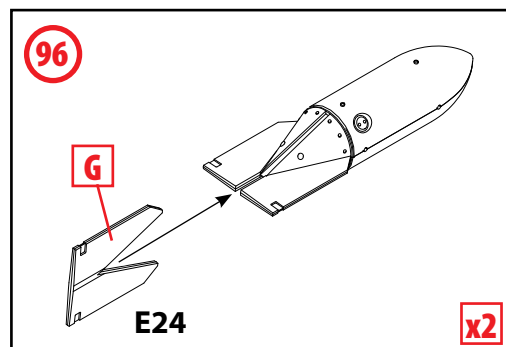
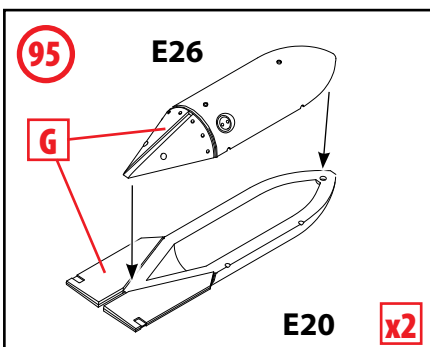
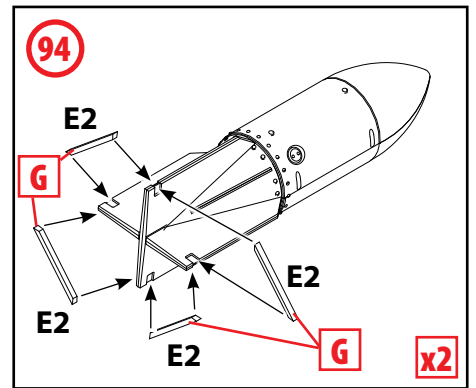
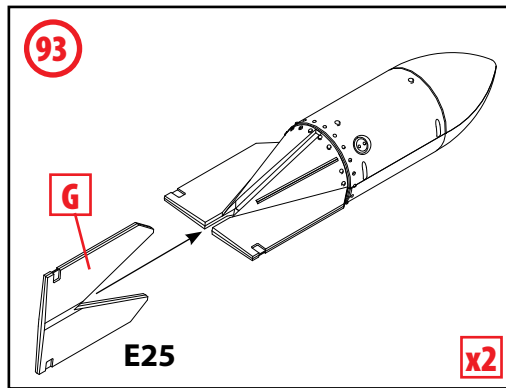
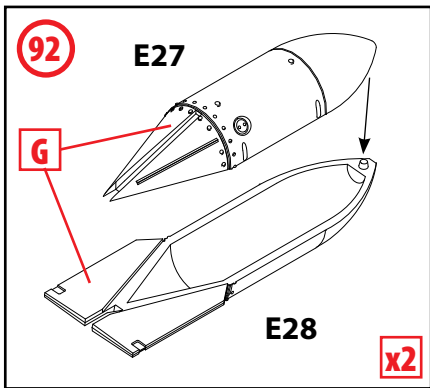
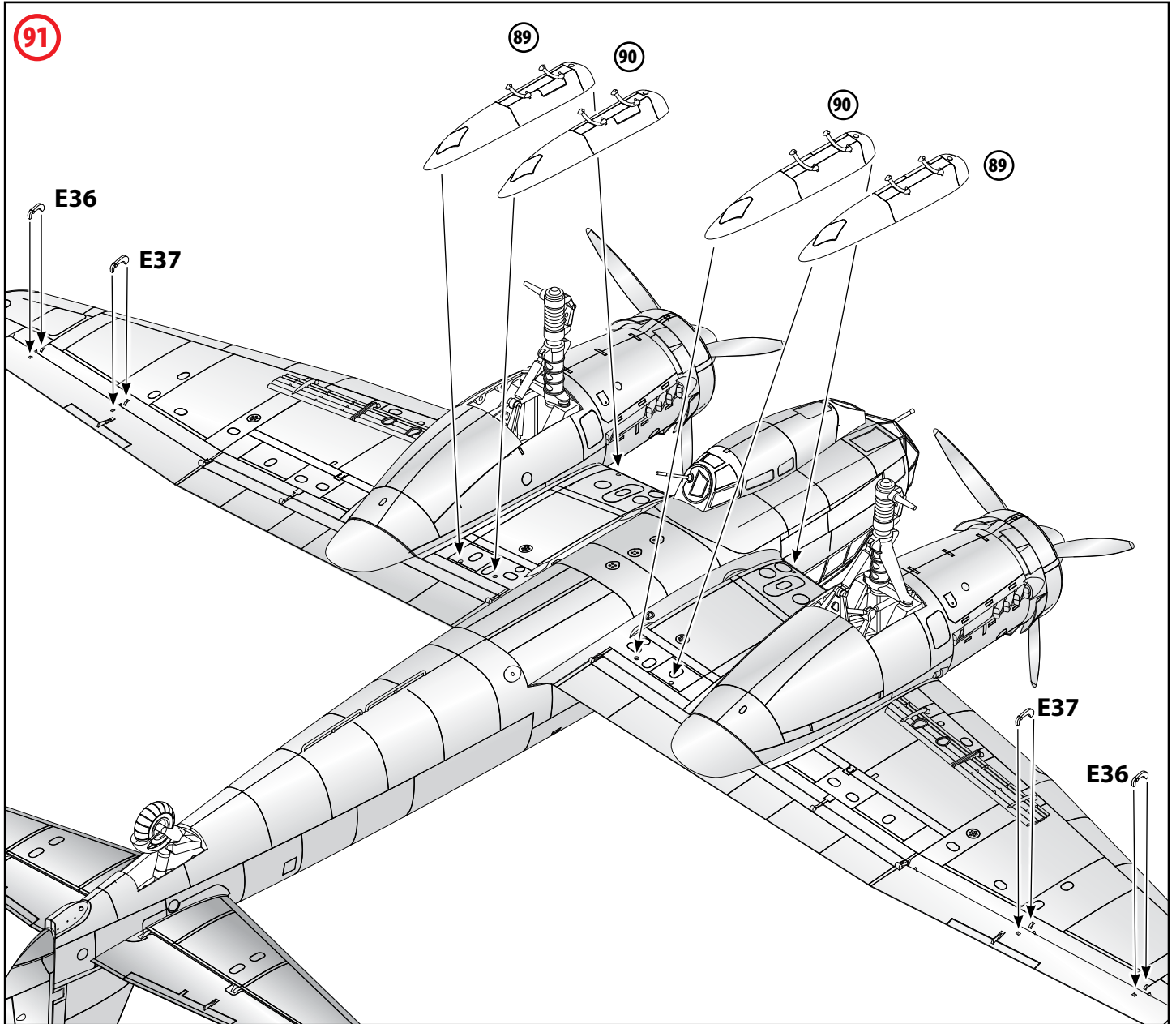

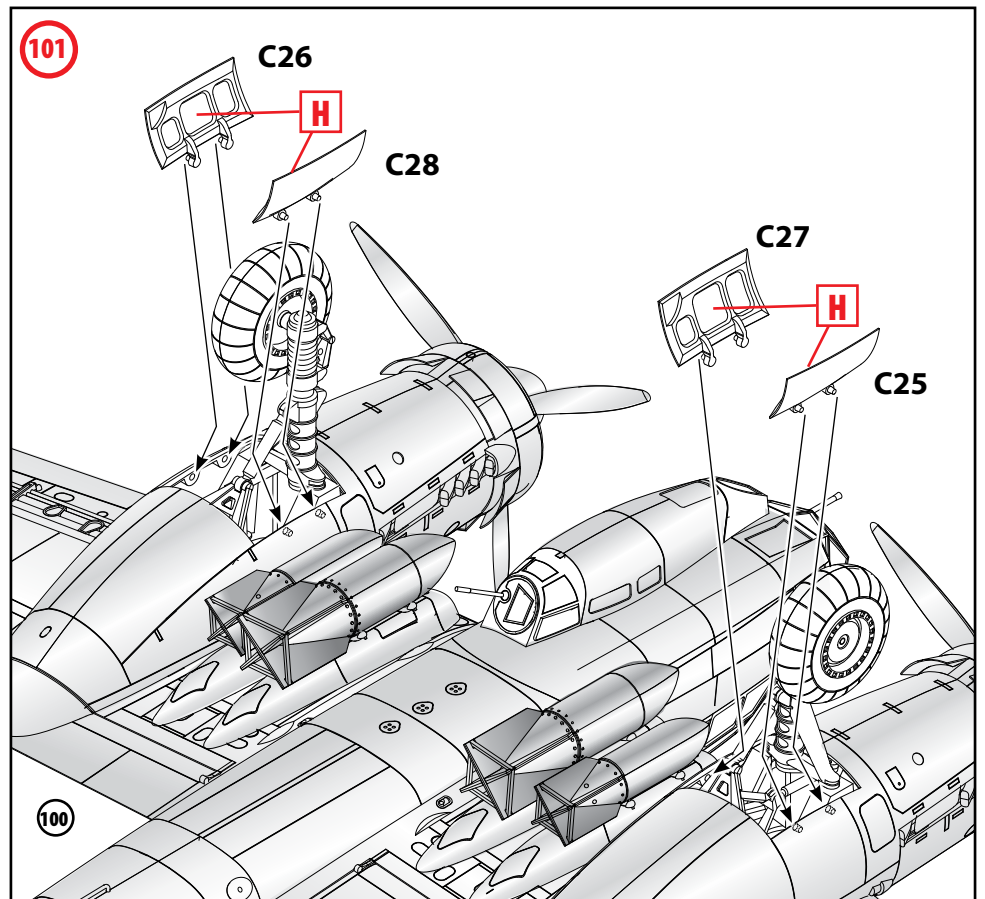
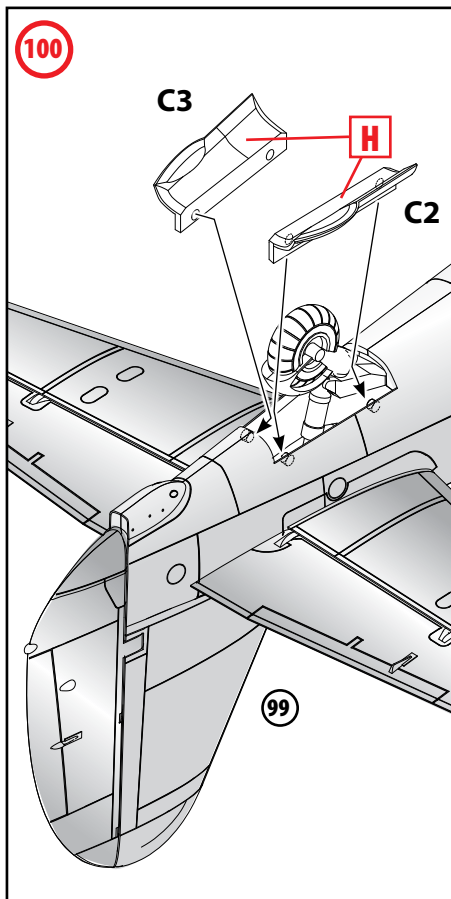
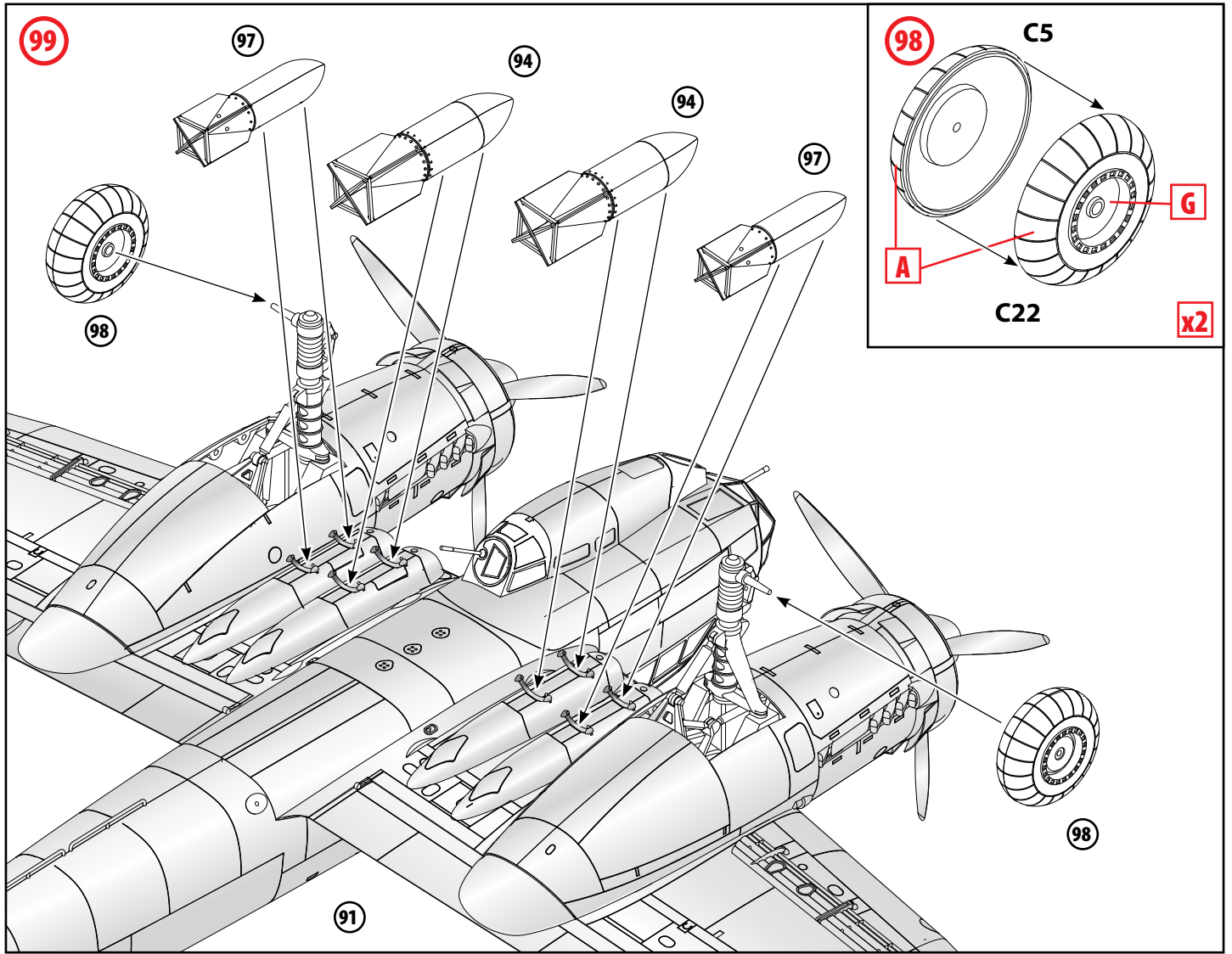

102 Для вариантов 1, 2, 4
For variants 1, 2, 4

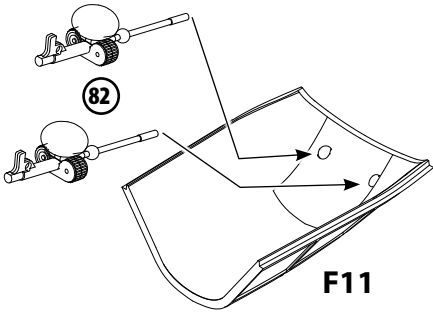

102 Для варианта 3
For variant 3

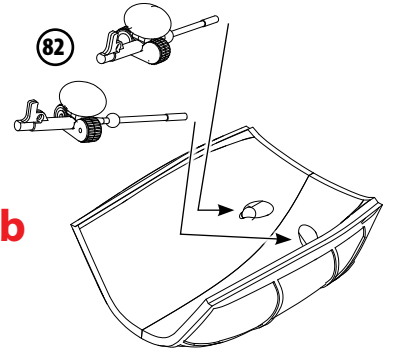
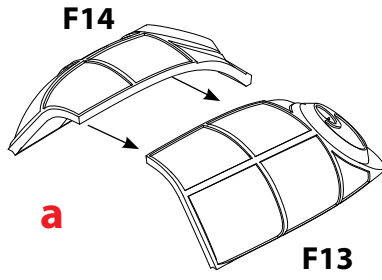

103

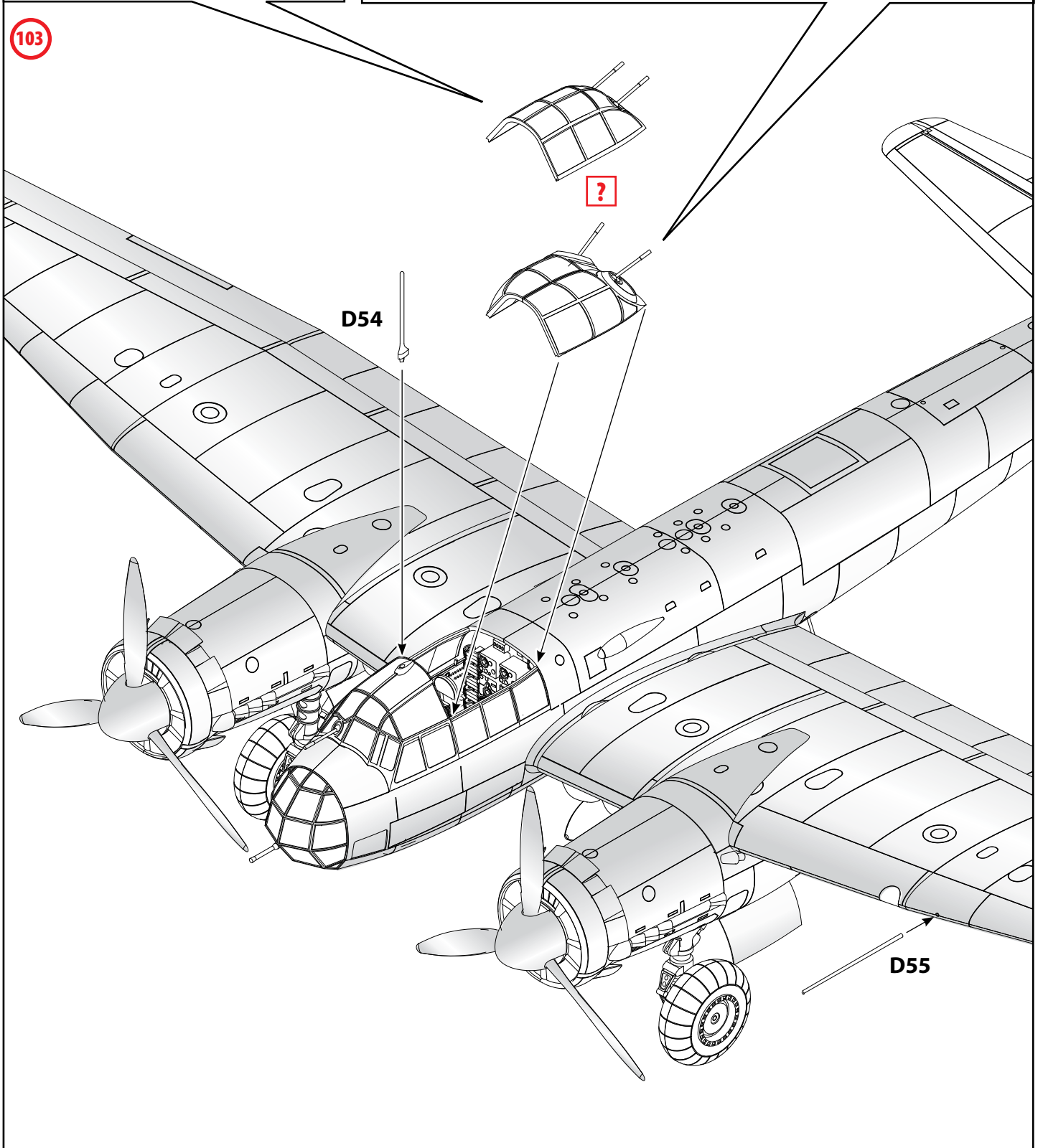

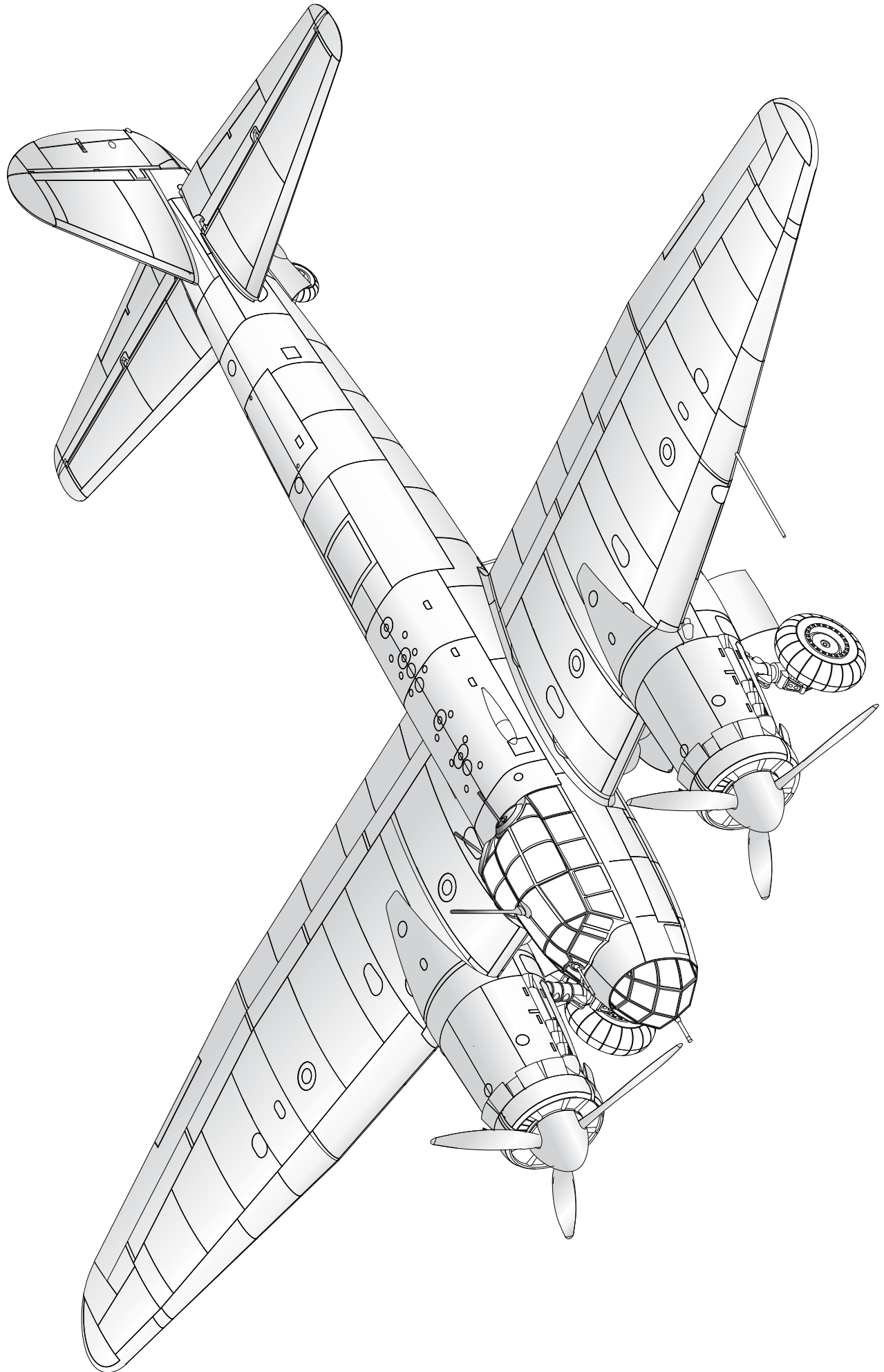

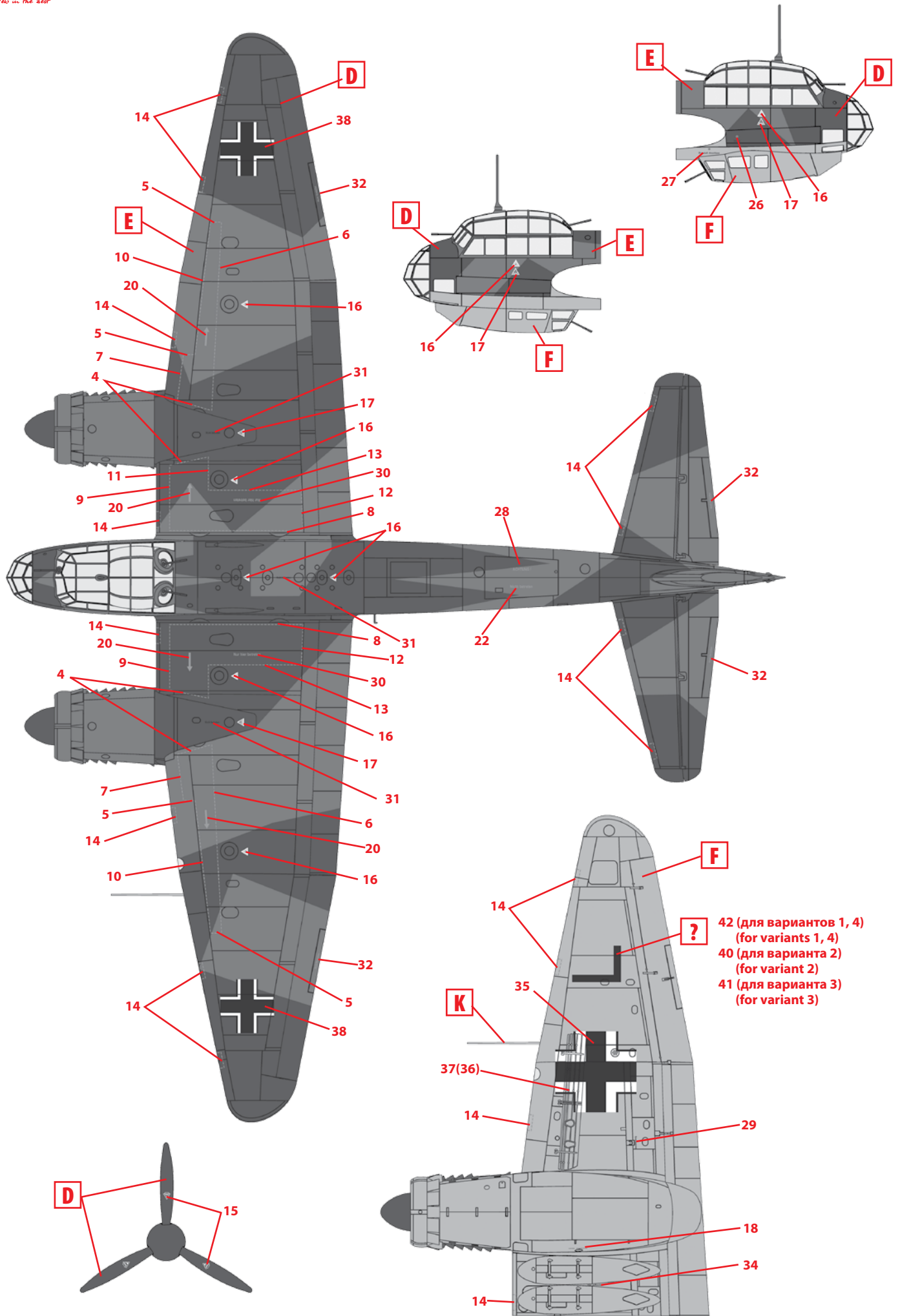

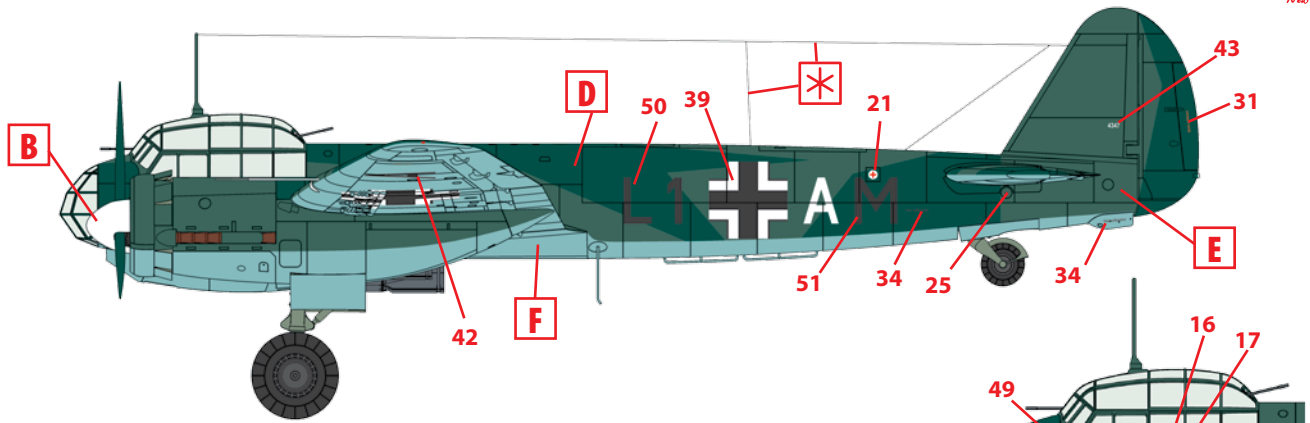

1. Junkers Ju 88A-5, 4./LG 1, Франция, август 1940 г.
 Junkers Ju 88A-5, 4./LG 1, France, August 1940

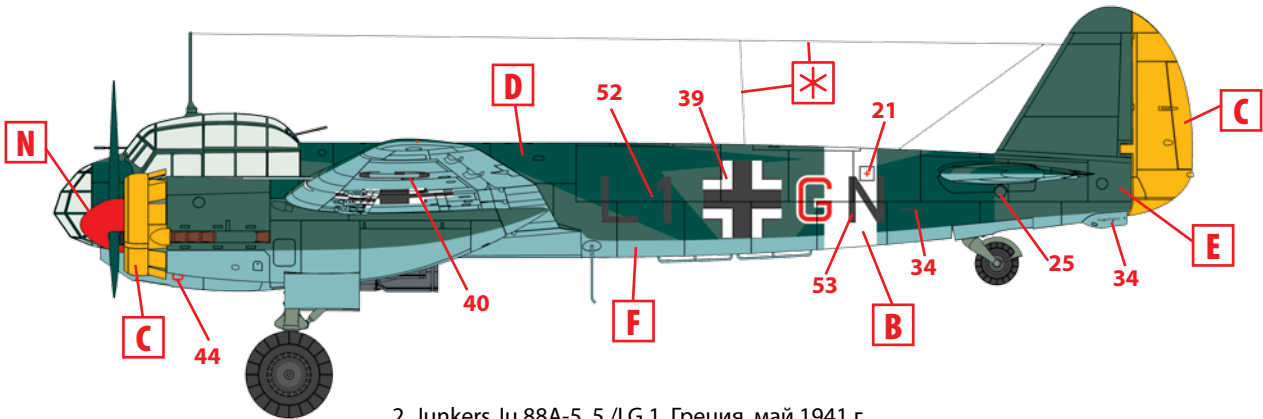
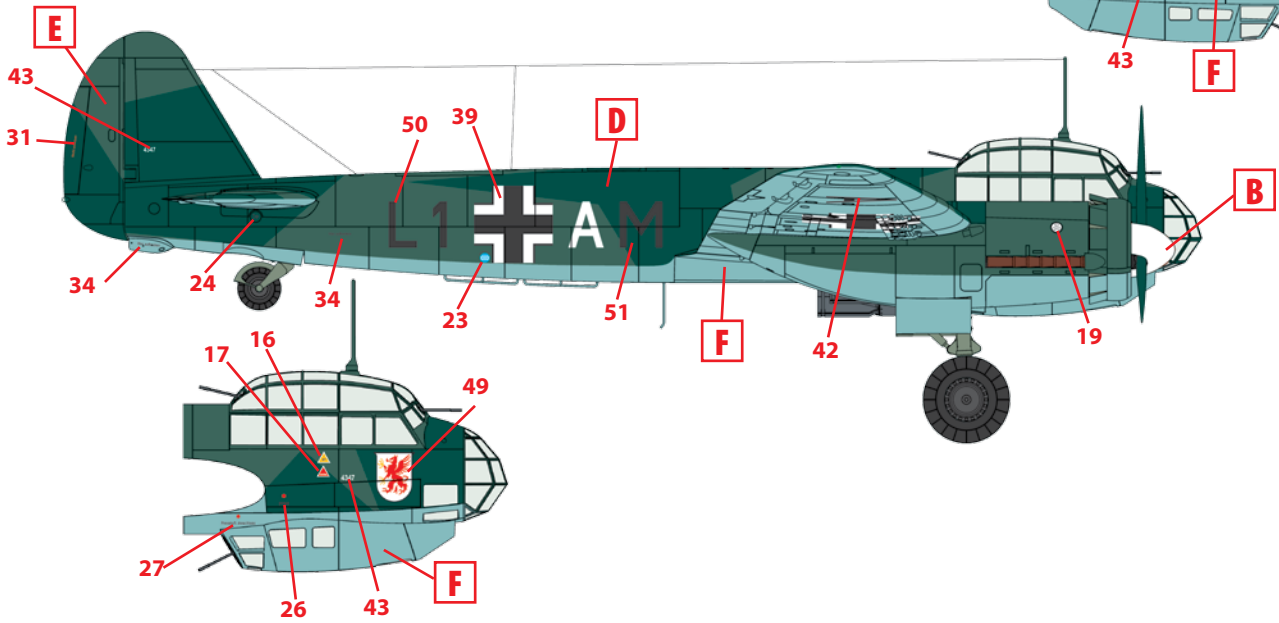
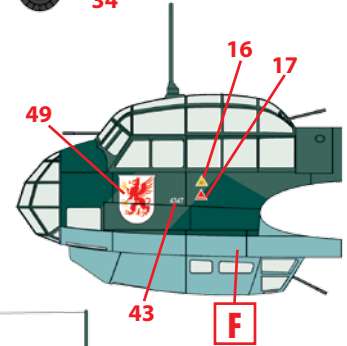

2. Junkers Ju 88A-5, 5./LG 1, Греция, май 1941 г.
 Junkers Ju 88A-5, 5./LG 1, Greece, May 1941

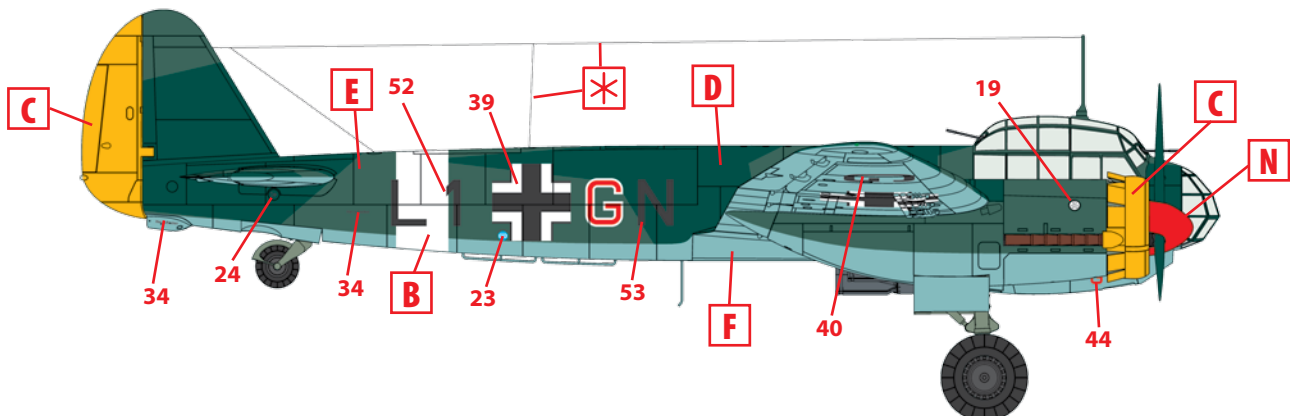

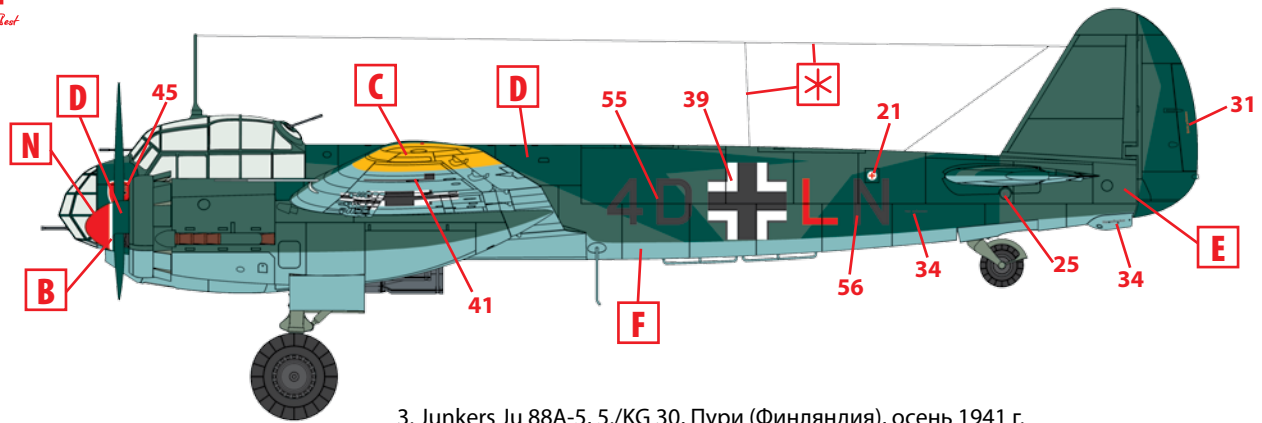

3. Junkers Ju 88A-5, 5./KG 30, Пури (Финляндия), осень 1941 г.
 Junkers Ju 88A-5, 5./KG 30, Puri (Finland), Autumn 1941

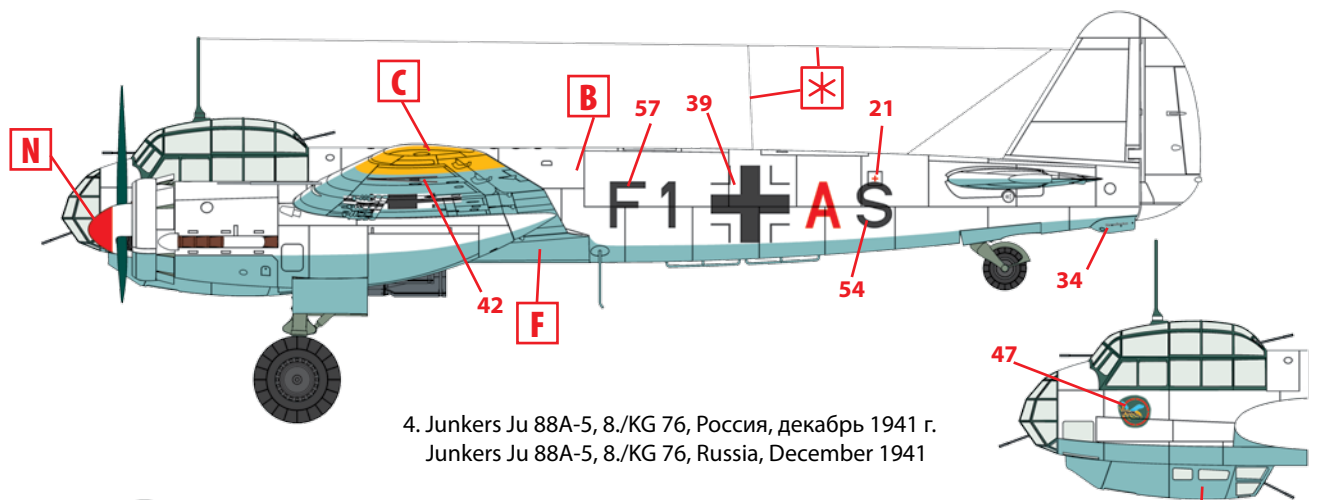
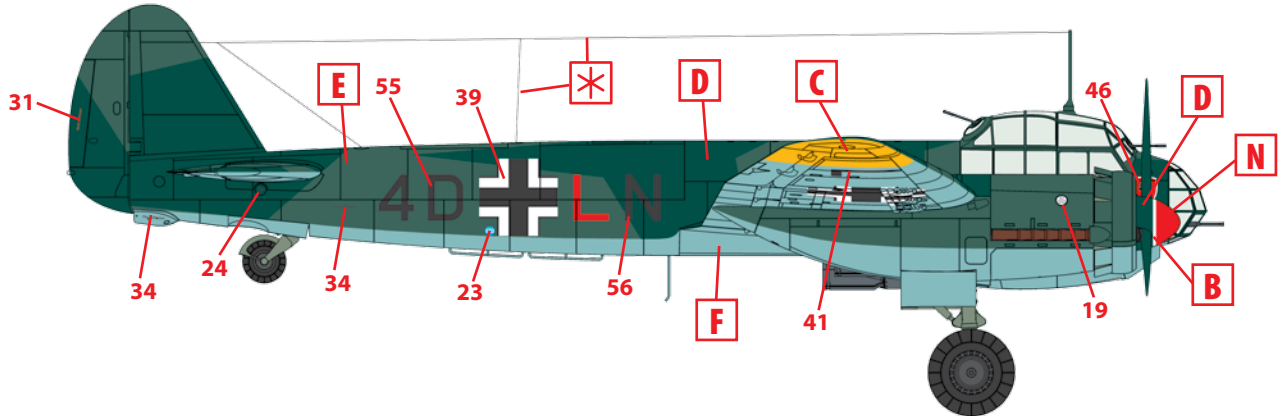

4. Junkers Ju 88A-5, 8./KG 76, Россия, декабрь 1941 г.
 Junkers Ju 88A-5, 8./KG 76, Russia, December 1941

