

F-4E 80-312  
3rd T.F.W. CLARK A.F.B. PHILLIPINES  
NOV. 1979 COL. McINERNEY

GRAY NUMBERS AND LETTERS  
PACAF BADGE BOTH SIDES

3rd TFW BADGE PORT SIDE ONLY

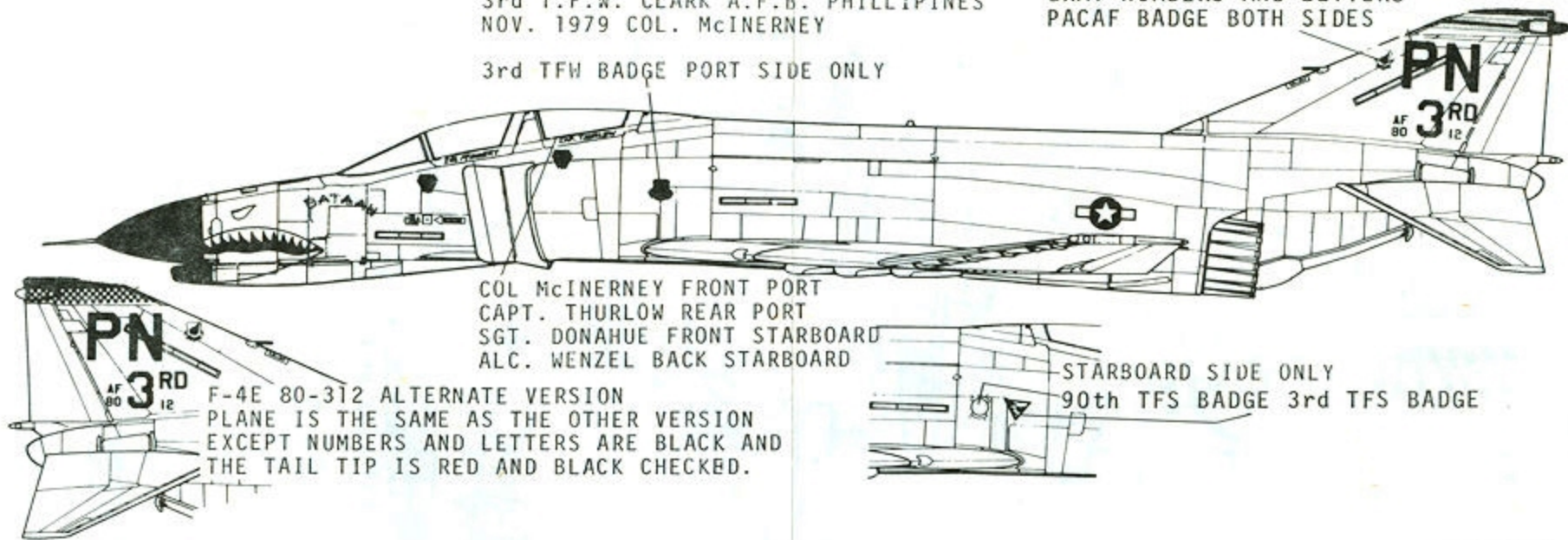

COL McINERNEY FRONT PORT  
CAPT. THURLOW REAR PORT  
SGT. DONAHUE FRONT STARBOARD  
ALC. WENZEL BACK STARBOARD

F-4E 80-312 ALTERNATE VERSION  
PLANE IS THE SAME AS THE OTHER VERSION  
EXCEPT NUMBERS AND LETTERS ARE BLACK AND  
THE TAIL TIP IS RED AND BLACK CHECKED.

F-4D 67-678  
4th T.F.W. CO. SEYMOUR JOHNSON A.F.B. N.C.  
MARCH 1969 COL. CHUCK YEAGER.

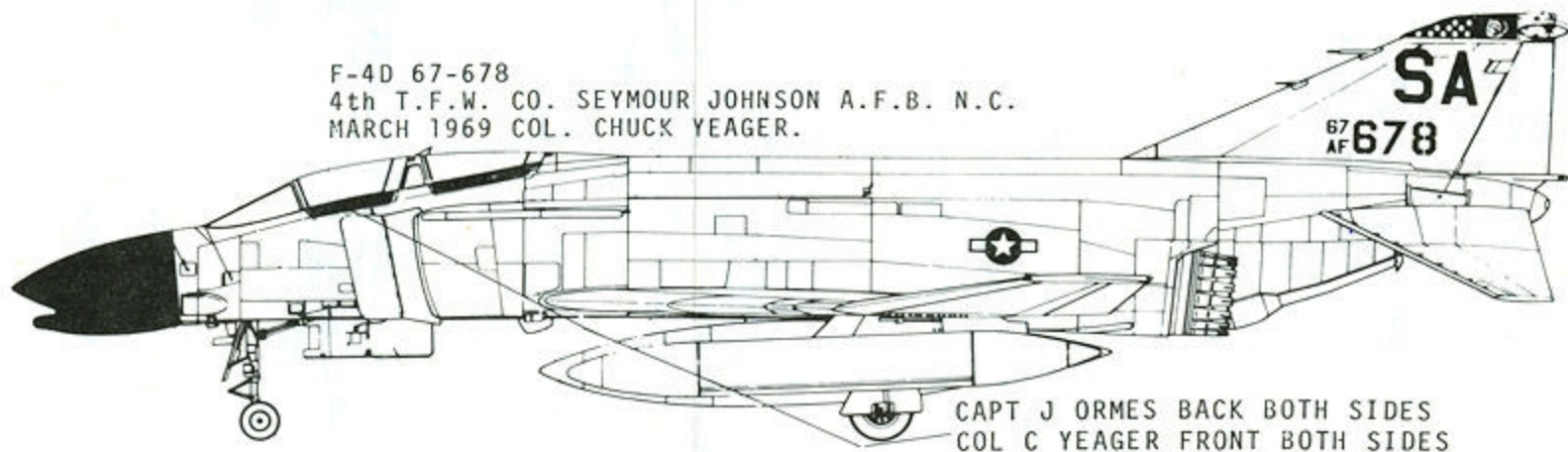

CAPT J ORMES BACK BOTH SIDES  
COL C YEAGER FRONT BOTH SIDES



CAMOUFLAGE VIEWS ARE SHOWN ONLY FOR PAINTING PURPOSE  
 THEY ARE NOT NECESSARILY THE F-4 VERSION ON THIS SHEET.

48-147

- GRAY FS36622
- GREEN FS34102
- BURNT METAL
- TAN FS30219
- DK. GREEN FS34079

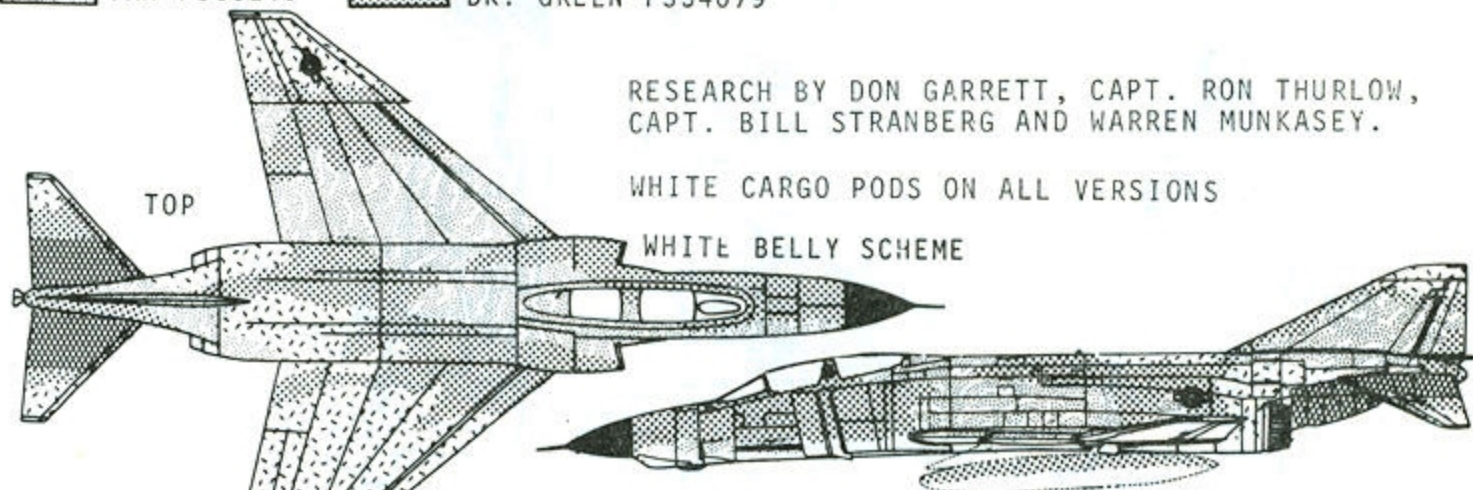

RESEARCH BY DON GARRETT, CAPT. RON THURLOW,  
 CAPT. BILL STRANBERG AND WARREN MUNKASEY.

WHITE CARGO PODS ON ALL VERSIONS

THIS IS AN AVERAGE REPRESENTATIVE OF MARKINGS  
 TO BE FOUND ON THESE AIRCRAFTS. SHOULD YOU WISH TO  
 FINISH YOUR MODEL WITH ALL OF THE FACTORY STENCILING  
 AND INCLUDING ACCESS DOOR MARKINGS YOU MUST BUY  
 48-76 WHITE STENCILING 48-67 BLACK STENCILING

FUSELAGE TOP

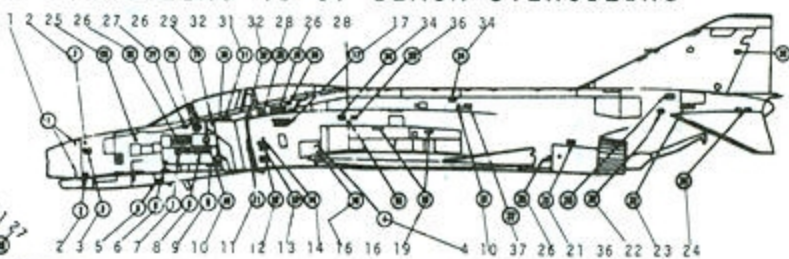
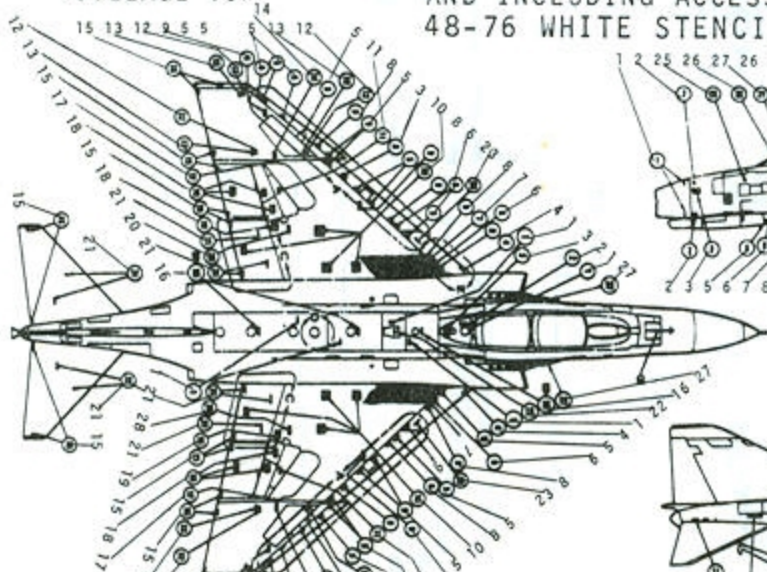

FUSELAGE LEFT SIDE

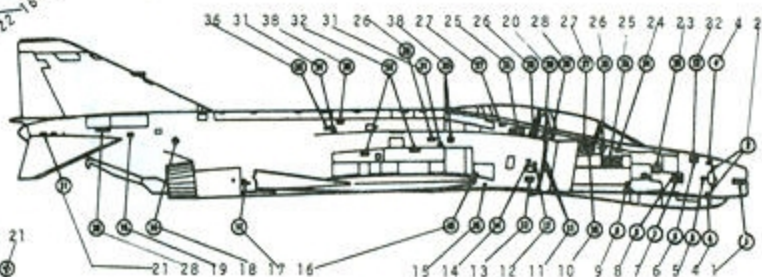

FUSELAGE RIGHT SIDE

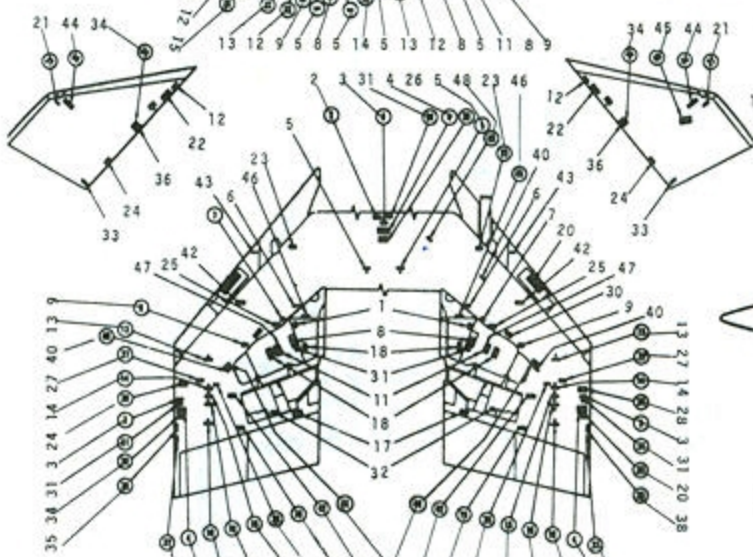

BOTTOM WINGS

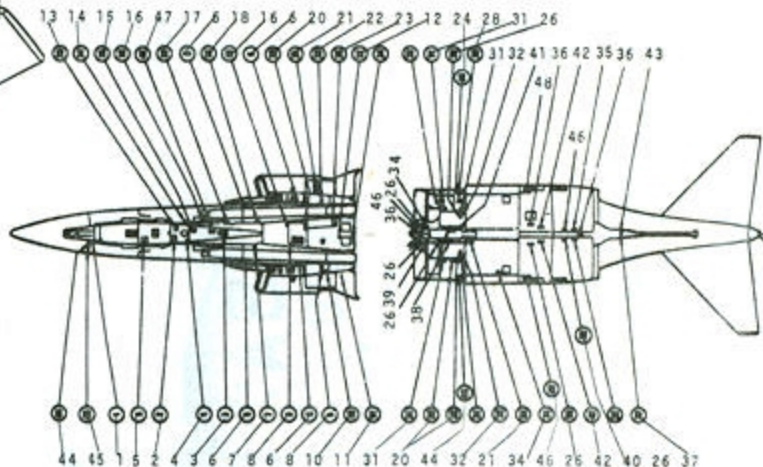

FUSELAGE BOTTOM

ALL MARKINGS SHOWN HERE ARE NOT ON THE  
 DECAL SHEET