

assembly instructions

Follow numbered steps carefully for ease of assembly

NO-SHOW CEMENTING is designed into your kit. The parts have been specifically engineered to enable you to complete a model which is free of bumps and smears. The instructions and drawings have also been designed to carry out the "NO-SHOW" cementing feature, through the use of blue lines to indicate cementing areas. These design features will enable you to obtain faultless results and reward you with a model you will be proud to display.

1. Firstly, locate and fit pieces together, prior to cementing.

2. Then, APPLY CEMENT SPARINGLY ONLY TO THE AREAS INDICATED IN BLUE ON THE INSTRUCTION DRAWINGS. Hold or clamp parts until a permanent bond is secured.

LEGEND

- Cementing area.
- Special "No-Show" Cementing Points. Apply cement here after parts are in assembled position.

1 wheels, hull, ammo storage

CHECK FIT OF PIECES AND TRIM IF NECESSARY

Cement as shown Hull Side, Left and Right (1-2), to Hull Bottom (10). Allow to dry. Position as shown and insert pin in Ammo Storage Cover (11) into hole provided on Back Side. Pin on other end can be inserted into opposite Side by gently forcing Side and allowing pins to enter into Cement Ammo Storage Floor (14) to Bottom.

Fit right Outside Road Wheel (3) and right Inside Road Wheel (4). Join Road Wheels by applying

cement to areas shown. Join Drive Wheels, Outside and Inside (5-6), in same manner.

Place hole in Road Wheel Arm (7) over pin on assembled Hull Side as shown. Without cementing, place four assembled Road Wheels on protruding pins on Arms and Hull Side.

Suspension Rail-Left (9) is joined to Hull Side, applying cement as shown. Assembled Drive Wheel is placed on remaining pin without cementing.

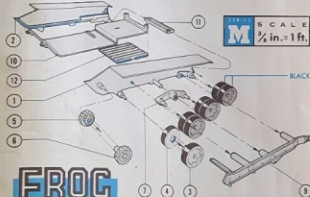

**FROG
DE-LUXE
MODELS**

NOTE: Circled numbers are ONLY for parts identifications, and have no bearing on the assembly sequence.

2 flexible tracks



Flexible Track (32) can now be fastened to assembly by passing end of Track over Drive Wheel and engaging teeth on Track with teeth on Drive Wheel. Continue threading Tracks completely around Road Wheels until two ends are positioned for fastening. See separate detail drawing for correct assembly procedure.

Duplicate previous procedure for right side of Hull using Suspension Rail-Right (8) and corresponding Road Wheels, Drive Wheels and Road Wheel Arms.

Check assembled Track action by pushing assembly along flat surface and over an obstacle such as a pencil or artist's tooth handle. Set assembly aside.

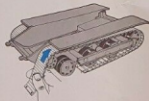

3 swivel turret, hatch, controls

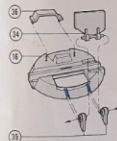

Fit Swivel Turret (16), Commander's Hatch Door (18) and two Commander's Hatch Hinges (19). Very carefully place a small amount of cement into one corner of Turret and insert Hinge. Before cement hardens, insert pin on Hatch Door into Hinge just assembled, making certain Hinge and Hatch are positioned correctly, by checking fit of Hatch in Turret. Carefully place a small amount of cement into remaining corner in Turret. Position hole in other Hinge over pin on Hatch and insert Hinge into turret. Hatch should open and close freely. Cement Periscope Shield (20) to Turret.

Without cementing, Turret is now inserted into opening in Hull Top (20). Turn entire assembly upside down and carefully apply cement to flange "U" shaped recesses in Turret. Position as shown and insert Turret and Elevating Hand Wheels (17-18). Complete assembly by positioning Fire Control Box (19) into remaining receptacle. Turret should rotate freely.

NOTE: LIGHT GREY TONE INDICATES INDIVIDUAL PARTS. DARKER GREY TONE INDICATES PARTS THAT HAVE BEEN ASSEMBLED.

4 top plates, hatch, lights, doors, tools

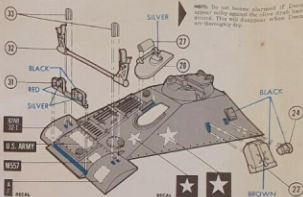

NOTE: Do not become alarmed if Details appear rusty and the olive drab lacks sheen. This will disappear when Details are thoroughly dry.

CHECK FIT OF PIECES AND TRIM IF NECESSARY

Apply cement to areas indicated and join Front Lights Section (24) to Hull Top.

Assemble Driver's Hatch (26) to Driver's Hatch Hinge (25) as shown and insert Hinge into recesses provided on Hull Top. Cement Hinge previously by applying cement from underside of Hull Top. Hatch should operate freely.

Assemble Gun Travelling Lock and Hinge (23-25) to Hull Top by inserting Hinge into recesses provided and cement from underside of Hull Top. Gun Travelling Lock should pivot freely.

Cement Rear Lights, Left and Right (24-25) to Hull

by inserting tabs on Lights into openings provided. Apply cement to tabs from underside of Hull Top. Cement Water Tank (22) to Hull Top.

Position as shown and cement Tool Box (21) to Hull Top. Position as shown and insert locating tabs on Maffler (23) into openings provided and apply cement from underside of Hull Top.

Assemble Rear Door Hinge (20) to Rear Left Door (24) and insert Hinge into tabs on Hull Top and carefully apply cement to Hinge from underside of Hull Top. Repeat procedure for Right Door (24). Doors should operate freely.

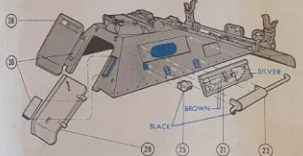

5 recoilless rifles, breech locks

CHECK FIT OF PARTS AND TRIM IF NECESSARY

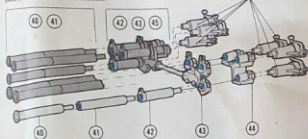

1. Before proceeding with the following instructions study drawings very carefully to avoid incorrect assembly of Gun Barrels.

Apply cement to areas indicated and assemble six Gun Barrels (40) to Gun Mount Swivel (43) by inserting brass pin (42) shaped studs into "D" shaped holes. Make sure to seat and align properly. Allow cement to dry.

Use no cement to assemble six Breech Locks (41) to six Breeches (40) by inserting brass pin (42) into opening in Breech as shown in separate drawing.

New place cement into "D" shaped holes in previously assembled Breech Housing and holding Breech Lock in closed position, join each Breech to Housing inserting "D" shaped studs into "D" shaped holes. Allow to dry.

Six previously assembled Gun Barrels are now assembled as shown.

PARTS LIST FOR YOUR SERIES M557 ONTOS

1	HULL—LEFT SIDE	26	HULL TOP	38	REAR DOOR STOP—LEFT
2	HULL—RIGHT SIDE	27	TOOL BOX	39	REAR DOOR STOP—RIGHT
3	OUTSIDE ROAD WHEEL (6)	28	WATER TANK	40	GUN NOZZLE (6)
4	INSIDE ROAD WHEEL (6)	29	MUFFLER AND EXHAUST PIPE	41	GUN BARREL—RIGHT (3)
5	ROD DRIVE WHEEL (2)	30	REAR LIGHT—LEFT	42	GUN BARREL—REAR (6)
6	OUTSIDE DRIVE WHEEL (2)	31	REAR LIGHT—RIGHT	43	GUN MOUNT SWIVEL
7	ROAD WHEEL ARM (2)	32	DRIVER'S BRIDGE	44	BREECH LOCK—LEFT
8	SUSPENSION BAR—RIGHT	33	DRIVER'S SWITCH	45	BREECH LOCK—RIGHT
9	SUSPENSION BAR—LEFT	34	REAR DOOR—LEFT	46	BREECH LOCK (6)
10	HULL BOTTOM	35	REAR DOOR—RIGHT	47	GUN MOUNT RETAINER
11	ARMED STORAGE COVER	36	FRONT LIGHTS SECTION	48	RATCHET GUN MOUNT
12	ARMED STORAGE FLOOR	37	GUN TRAVELING LOCK	49	RATCHET GUN SWIVEL
13	MOTOR FIREWALL	38	GUN TRAVELING LOCK WING (2)	50	MACHINE GUN
14	COMMANDER'S SEAT	39	1 LITRE	51	FLEXIBLE TRACK (2)
15	COMMANDER'S SEAT BACK REST	40	COMMANDER'S HATCH DOOR	52	DRAINER
16	SNAIL TURBINE	41	COMMANDER'S HATCH DOOR WING (2)	53	1 LITRE
17	TRACERSHIP HORN WHEEL	42	PERISCOPE SHIELD	54	ROCKET (6)
18	ELEVATING HORN WHEEL	43	ROCKET (6)		
19	FIRE CONTROL BOX				

6 final assembly

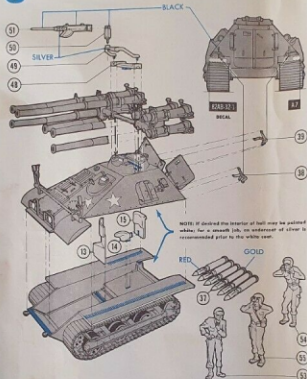

NOTE: If desired the interior of hull may be painted white; for a smooth job, an undercoat of silver is recommended prior to the white coat.

CHECK FIT OF PARTS AND TRIM IF NECESSARY

Cement Motor Firewall (13) to Hull Bottom.

Cement Commander's Seat (14) into slot in Commander's Seat Back (12). Cement seat assembly to Hull Bottom.

Now join Hull Top to Hull Bottom by applying cement to areas indicated in blue tone at front. Complete the joining operation by applying cement from inside through rear door opening to the special "see show" connecting joints indicated.

Cement Rear Door Stop Left and Right (38-39) as shown in separate detail drawing. Gun Assembly is now attached to Turret by very care-

fully APPLYING cement to areas indicated and carefully interlocking Gun Mount Swivel between Turret and Gun Mount Retainer (48). Gun assembly should elevate freely.

Cement Machine Gun Mount (49) to Retainer. Carefully snap Machine Gun (50) into Machine Gun Swivel (48). Insert key on Swivel into exhaust provided on Mount. Unit should pivot freely.

Crew members can be painted and positioned in as one of the vehicle as desired.

To complete your Model insert six Rockets (54) into Armed Storage box at rear of Tank.



INTERESTING FACTS about your MULTIPLE 106 MM RECOILLESS RIFLES

Ontos (from Greek: "The Thing") is a lightly armoured vehicle developed by the Alfa Romeo Company for Army Ordnance and the U.S. Marine Corps, according to specifications based on a new concept in armoured warfare.

A low, powerful-looking silhouette moves rapidly into the field, spots a low profile of 106-caliber tanks seeking its target—then lets loose a terrible salvo from six big rifles. Before you can get a good look at it, the thing whirrs and vanishes.

Instead of carrying one artillery piece, as is the case with tanks, Ontos carries six 106mm recoilless rifles. Instead of heavy protective armor it depends on the speed with which its rifle can be trained on target and its high maneuverability. Because of these characteristics it has been called a hit-and-run weapon.

Ontos carries six rather sporting rifles. Coming within range of the target the Ontos glides from this sporting rifle until the bullet flashes on the target! And the gunner, thus firing the previously loaded rifle, if necessary to insure a kill, all six may be fired. The

Ontos then quietly turns to find cover for reloading the rifle.

Officially designated "Hoffa, Multiple, 106mm, Self-Propelled, M57," the new weapon is an 8 1/2-Ton, full tracklaying, front approach vehicle. Two of its six rifles may be depressed for ground use. It also carries four rather 10 sporting rifles and one rather 30 machine gun.

The six major caliber weapons may be fired independently, in salvoes of two (200 ft range), or in a salvo of six from the gunner's position inside the vehicle.

Either the major or minor weapons may be fired by either a self-pull or a hand trigger. When rifles have all been fired, members of the crew must leave the vehicle to reload the fully exposed weapons; hence the vehicle would usually seek cover for that operation.

The vehicle is powered by a General Motors 114 horsepower engine, the same as that used in the 1 1/2 ton Army truck. Speed is in the middle range and climbing ability excellent since Ontos will climb a 60 percent grade or crawl over a 1/4 ft vertical wall with equal ease.

YOUR FROG DE-LUXE MODEL

This Multiple 106 mm Recoilless Rifle ONTOS is another in a series of models developed for rapid production by specifications contained in official U.S. Army Blueprints. We wish to take this opportunity to express our gratitude to the U.S. Army Ordnance Corps, and the Office of the Chief of Information and Education, for generously furnishing complete and accurate data. Without this cooperation, the Agapac model of a completely authentic model would not have been possible.

PAINTING YOUR MODEL

Essentially, your model has been outlined in sufficient detail for you to paint and finish, and hand for orders of Olive Drab for hull and turret, and black for the machine track. However, it is recommended that certain small joints be painted to provide additional realism. Therefore, if you intend to paint your model, we recommend that you fully examine all the steps in the instructions about the items requiring decoration. Complete the painting of all of these points prior to assembly, making certain to avoid getting paint on

recessed areas. Use only enamel paints and allow sufficient drying time. Recommended tools for painting are a small (#1) artist's brush, and the end of a toothpick or spread paper clip for minute detailing, such as nuts, rivet heads, etc.

GENERAL INSTRUCTIONS

A. Notice that all parts are identified with a part number which is either stamped on the back of the piece or on a small identification disc. Remove this disc now, properly identify it with the assembly job, and store it.

B. Examine pieces and remove any other excess plastic with a sharp knife blade, making sure all protrusions have been removed. X-Acto knife sets are very handy for trimming and may be purchased at all hobby counters.

C. Particular Frog cement for polystyrene plastic at your local store. Have a small cloth handy to wipe any excess. You may occasionally get on your fingers.

D. See back of decal for instructions on how to apply.